



National Alliance to
END HOMELESSNESS



NATIONAL CONFERENCE ON ENDING FAMILY HOMELESSNESS

Conference Program

FEBRUARY 12 – 13, 2009 | SHERATON SAN DIEGO HOTEL & MARINA | SAN DIEGO, CA



ENDING HOMELESSNESS... ...MAKING PROGRESS IN A TIME OF CHALLENGE!

*F*or the first time since the rise of homelessness more than 25 years ago, communities have been able to articulate a detailed, practical strategy for ending homelessness among families with children: a strategy that works.

Leading communities are using proven program models and systemic reforms to save children and their parents from homelessness. These communities are rapidly moving families from shelters and the streets back into housing, finding families who are about to lose their housing and heading off the crisis, and targeting the most intensive interventions where they are most critically needed.

And, these communities have achieved results: in those that have concentrated on getting programs right and have made the tough decision to focus on solutions, the number of families that bear the trauma and pain of homelessness has declined.

Today's economy makes the path toward ending homelessness steeper. With rising unemployment and housing problems caused by foreclosures, some communities are finding more families falling into homelessness. This challenges the homelessness system to be more effective, while stressing the importance of larger efforts to improve incomes and make housing more affordable.

At the same time, there are significant opportunities. In a season of political change, new leaders will be looking for meaningful and practical new undertakings. Recent events have highlighted the importance of housing affordability, and significant new resources will most certainly be invested in housing over the next few years. Further, the critical role the public sector must play in creating a workable housing system in the nation has been underscored. Finally, people working on homelessness have developed an impressive track record that is becoming better known. And, all of this is taking place in an environment that is open to improvement and change to increase effectiveness and achieve goals.

Amid these trends and counter-trends, the National Alliance to End Homelessness welcomes you to its fifth national conference aimed specifically at ending homelessness among families with children: Making Progress in a Time of Challenge. We are looking for ways to work together, cross borders, and make progress. We are glad you are joining us to learn about the most effective practices and to share what is happening in your community, so that together we can put an end to family homelessness.



TABLE OF CONTENTS

CONFERENCE PARTNERS AND SPONSORS	2
CONFERENCE AT A GLANCE	3-5
CONFERENCE AGENDA, WEDNESDAY	6
CONFERENCE AGENDA, THURSDAY	6-11
CONFERENCE AGENDA, FRIDAY	11-15
PLENARY SPEAKER BIOGRAPHIES	16
WORKSHOP SPEAKER BIOGRAPHIES	17-38
WORKSHOP SPEAKER CONTACT INFORMATION	39-44
ABOUT THE ALLIANCE	45
ALLIANCE BOARD OF DIRECTORS	46
CONFERENCE SCHOLARSHIP PROGRAM	47
NOTES	48
HOTEL MAP	49



CONFERENCE PARTNERS

Building Changes
Center for Urban Community Services
Common Ground
Corporation for Supportive Housing
Episcopal Community Services
Horne Family Foundation
Housing Assistance Council
Local Initiatives Support Corporation
Mercy Housing
National AIDS Housing Coalition
National Alliance on Mental Illness
National Center for Housing and Child Welfare
National Center on Family Homelessness
National Coalition Against Domestic Violence
National Coalition for Homeless Veterans
National Coalition for the Homeless
National Council of State Housing Agencies
National Foster Care Coalition
National Law Center on Homelessness and Poverty
National Low Income Housing Coalition
One Family, Inc.
Regional Taskforce on the Homeless San Diego

CONFERENCE SPONSORS

Leadership Sponsor

Horne Family Foundation

Investing Sponsor

Mercy Housing

Contributing Sponsor

Local Initiatives Support Collaboration

Associate Sponsor

Center for Urban Community Services

Partnering Sponsor

Common Ground
Corporation for Supportive Housing
Episcopal Community Services
National Center on Family Homelessness
Regional Taskforce on the Homeless San Diego



CONFERENCE SCHEDULE AT A GLANCE

DATE	TIME	EVENT	LOCATION
Wednesday, February 11	5:00 pm-7:00 pm	Registration	Harbor Island Foyer
Thursday, February 12	8:00 am-5:00 pm	Registration	Harbor Island Foyer
	8:00 am-9:00 am	Coffee/Tea	Harbor Island Foyer
	9:00 am-10:00 am	Opening Plenary <ul style="list-style-type: none"> Nan Roman, President and CEO, National Alliance to End Homelessness, Washington, DC Introduction of Mayor Sanders: Walt Sandford, Executive Director, Regional Task Force on the Homeless, Inc., San Diego, CA The Honorable Jerry Sanders, Mayor, San Diego 	Harbor Island II & III
	10:15 am-12:15 pm	Workshops I <ul style="list-style-type: none"> Affordable Housing: Sustainable Solutions Client-Centered, Trauma-Informed, and Culturally-Proficient Practice Employment and Income Strategies Ending Family Homelessness: Moving from Planning to Implementation Introduction to Ending Family Homelessness Preventing Veteran Homelessness: Helping Families Program-Level Performance Improvement Research on Family Homelessness 	Executive 2A & 2B
			Executive Center I
			Marina 3
			Marina 6
			Executive 3A & 3B
			Marina 2
			Spinnaker
12:30 pm-2:00 pm	Lunch/Plenary/Keynote <ul style="list-style-type: none"> Special Recognition: Tanya Tull, President and CEO, Beyond Shelter, Los Angeles, CA Promoting Systems Change 	Seabreeze	
2:15 pm-3:45 pm	Workshops II <ul style="list-style-type: none"> Building Political Power through Effective Advocacy Connecting Families to Health Care Services Domestic Violence: Improving Responses, Expanding Options 	Harbor Island II & III	
		Executive 2A & 2B	
		Marina 3	
			Executive Center I



DATE	TIME	EVENT	LOCATION	
Thursday, February 12	2:15 pm-3:45 pm	Workshops II (Continued) <ul style="list-style-type: none"> • Engaging Foundations • From Top to Bottom: Planning a Family Homelessness System • Housing First/Rapid Re-Housing for Families • Permanent Supportive Housing for Families • The Intersection of Child Welfare and Homelessness 	Marina 6 Executive 3A & 3B Seabreeze Spinnaker Marina 2	
	3:45 pm-4:00 pm	Break		
	4:00 pm-5:30 pm	Workshops III <ul style="list-style-type: none"> • Engaging Local and State TANF Agencies • Future of Federal Policy for Homeless Families • Getting on the Same Page: Systems Change • Harm Reduction and Family Well-Being • Preventing Family Homelessness • Short-Term and Shallow Rental Subsidies • Young Homeless Families: Serving the Entire Family • Facilitated Discussion: Leadership Challenges and Opportunities 	Marina 2 Executive 2A & 2B Spinnaker Marina 6 Seabreeze Executive 3A & 3B Executive Center I Marina 3	
	5:45 pm-7:00 pm	Reception with Cash Bar	Outdoor Lanai Area	
	Friday, February 13	8:00 am-1:00 pm	Registration	Harbor Island Foyer
		8:00 am-9:00 am	Continental Breakfast	Harbor Island Foyer
		9:00 am-10:30 am	Workshops IV <ul style="list-style-type: none"> • Assessment and Targeting: Matching Families with Resources • Federal Policy to End Family Homelessness • Improving Child Outcomes • Preventing and Ending Family Homelessness in Rural Communities • Prevention: Building a Coordinated Response 	Executive 2A & 2B Executive 3A & 3B Marina 6 Marina 3 Executive Center I



DATE	TIME	EVENT	LOCATION
Friday, February 13	9:00 am-10:30 am	Workshops IV (Continued) <ul style="list-style-type: none"> • Responding to Increases in Family Homelessness • Supporting Parents with Mental Health Disabilities • Working with Landlords 	Seabreeze Marina 2 Spinnaker
	10:30 am-10:45 am	Break	
	10:45 am-12:15 pm	Workshops V <ul style="list-style-type: none"> • Emergency Shelter and Interim Housing • Engaging your Public Housing Agency • Partnering with Community-Based and Faith-Based Organizations • Service-Intensive Interventions: Targeting and Design • Substance Use Treatment: Useful Tools for Providers • Systems-Level Performance Measurement • Transitional Housing • Facilitated Discussion: State and Local Change Agents 	Executive 2A & 2B Marina 2 Executive Center I Marina 6 Executive 3A & 3B Seabreeze Spinnaker Marina 3
	12:30 pm-2:00 pm	Lunch/Plenary/Keynote <ul style="list-style-type: none"> • Keynote Speaker Introduction: The Honorable Mike Lowry, Co-Chair, National Alliance to End Homelessness, Renton, WA • Lynn Rosenthal, Executive Director, New Mexico Coalition Against Domestic Violence, Albuquerque, NM • Conference Closing and Reflection: Sharon McDonald, Senior Policy Analyst, National Alliance to End Homelessness, Washington, DC 	Harbor Island II & III
	2:15 pm-3:30 pm	Workshops VI <ul style="list-style-type: none"> • Getting Better Outcomes from Your Continuum of Care • Managing and Building Political Will • Voluntary Case Management • Working with Undocumented Families • Facilitated Discussion: New Resources in Economic Recovery Legislation 	Executive Center I Marina 6 Spinnaker Marina 3 Seabreeze



CONFERENCE AGENDA | WEDNESDAY, FEBRUARY 11

5:00 pm-7:00 pm: Registration

Harbor Island Foyer

CONFERENCE AGENDA | THURSDAY, FEBRUARY 12

8:00 am-5:00 pm: Registration

Harbor Island Foyer

8:00 am-9:00 am: Coffee/Tea

Harbor Island Foyer

9:00 am-10:00 am: Opening Plenary

Harbor Island II and III

- Nan Roman, President and CEO, National Alliance to End Homelessness, Washington, DC
- Walt Sandford, Executive Director, Regional Task Force on the Homeless, Inc., San Diego, CA
- The Honorable Jerry Sanders, Mayor, San Diego

10:15 am-12:15 pm: Workshops I

Affordable Housing: Sustainable Solutions

Executive 2A & 2B

This workshop will explore opportunities to expand affordable housing options for low income families. Speakers will discuss using federal funding for development and acquisition, overcoming opposition to siting affordable housing, and developing partnerships with affordable housing providers.

- Damien Heath, National Alliance to End Homelessness, Washington, DC (Moderator)
- Matthew Packard, Father Joe's Village, San Diego, CA
- Jeff Schaffer, Enterprise Community Partners, Los Angeles, CA
- Bob Snow, National Affordable Housing Trust, Columbus, OH

Client-Centered, Trauma-Informed, and Culturally-Proficient Practice

Executive Center I

Client-centered practice requires a highly individualized service approach that is designed to respond to the expressed needs and desires of the client. Speakers will discuss how programs can enhance their capacity to tailor service interventions to families. Speakers will also examine how to build diversity and cultural proficiency within an organization and create awareness of how trauma can affect families.

- boona cheema, Building Opportunities for Self-Sufficiency, Berkley, CA
- Kathleen Guarino, National Center on Family Homelessness, Newton, MA
- Alfreda Igelhart, UCLA Department of Social Welfare, Los Angeles, CA
- LaKesha Pope, National Alliance to End Homelessness, Washington, DC (Moderator)
- John Selfridge, The Road Home, Salt Lake City, UT



Employment and Income Strategies

Marina 3

Increasing employment opportunities and accessing public benefits can help families achieve greater stability and well-being. This workshop focuses on programs dedicated to asset development, employment, and public assistance available to families experiencing homelessness.

- Evelyn Correa, Department of Homeless Services, New York, NY
- David Pollack, ICF International, Lexington, MA (Moderator)
- Yasmin Tarver, Beyond Shelter, Los Angeles, CA

Ending Family Homelessness: Moving from Planning to Implementation

Marina 6

Communities across the country that have adopted ten year plans to end homelessness are now focusing on implementing those plans. Speakers will discuss overseeing plans, bringing family providers together on common goals, evaluating progress, and confronting fiscal challenges.

- Liz Drapa, Corporation for Supportive Housing, Chicago, IL
- Sharan London, Montgomery County Coalition for the Homeless, Rockville, MD
- Jamie Van Leeuwen, Denver Department of Human Services, Denver, CO
- Aisha Williams, National Alliance to End Homelessness, Washington, DC (Moderator)

Introduction to Ending Family Homelessness

Executive 3A & 3B

Communities have developed a number of successful strategies for ending homelessness for families. Speakers will provide an overview of targeting prevention resources, rapid re-housing, and the strategic use of more intensive service models, such as transitional and permanent supportive housing.

- Gail Dorfman, Hennepin County, Minneapolis, MN
- Barbara Poppe, Community Shelter Board, Columbus, OH
- Robert Pulster, Massachusetts Interagency Council on Housing and Homelessness, Boston, MA
- Alice Shobe, Building Changes, Seattle, WA (Moderator)
- Tanya Tull, Beyond Shelter, Los Angeles, CA

Preventing Veteran Homelessness: Helping Families

Marina 2

Family and social supports help veterans successfully transition back into their homes and communities. This workshop will describe how housing service agencies house homeless veterans and their families. In addition, presenters will discuss ways they are working to identify veteran families who are at-risk of homelessness.

- Peggy Bailey, National Alliance to End Homelessness, Washington, DC (Moderator)
- Barbara Banaszynski, Volunteers of America, Alexandria, VA
- Marilyn Cornell, Veterans Village of San Diego, Inc., San Diego, CA
- Thomas Hameline, HELP USA, New York, NY

Program-Level Performance Improvement

Spinnaker

Performance measurement demonstrates to staff, funders, consumers, policymakers, and other stakeholders that a program is achieving its intended goal, and provides feedback to foster ongoing program improvement. Speakers will provide examples of effective program measurement tools and introduce the Alliance's Performance Measurement Toolkit.

- Meghan Henry, National Alliance to End Homelessness, Washington, DC (Moderator)
- Rob Smith, Second Chance, San Diego, CA
- Rick Wood, Rubicon Programs, Inc., Richmond, CA



Research on Family Homelessness

Seabreeze

Research is providing new insight into how homelessness among families can be prevented and ended. Leading researchers will share findings that are informing the development and refinement of homeless assistance programs and dispelling myths about homelessness among families.

- *Dennis Culhane, University of Pennsylvania, Philadelphia, PA*
- *Mary Cunningham, Urban Institute, Washington, DC (Moderator)*
- *Brooke Spellman, Abt Associates, Chicago, IL*

12:30 pm-2:00 pm: Lunch/Plenary/Keynote

Harbor Island II and III

- *Video and Special Recognition: Tanya Tull, President and CEO, Beyond Shelter, Los Angeles, CA*
- *Promoting Systems Change*

2:15 pm-3:45 pm: Workshops II

Building Political Power through Effective Advocacy

Executive 2A & 2B

Strengthening relationships with public officials helps build accountability and better policy. Speakers will discuss strategies for engaging policymakers, leading effective program tours, and working with local media.

- *Richard W. Brown, Monarch Housing Associates, Cranford, NJ*
- *Sarah Kahn, National Alliance to End Homelessness, Washington, DC (Moderator)*
- *Kate Kelly, Partnership for Strong Communities, Hartford, CT*

Connecting Families to Health Care Services

Marina 3

Homelessness and poor housing can take a toll on the health of individuals experiencing homelessness, particularly for children and adults who may already be in poor health. Providers can connect families with mainstream public health systems to address clients' needs. Speakers will provide tools to build partnerships and create service strategies to improve the health and well-being of low-income parents and their children.

- *Nancy Bernstine, National AIDS Housing Coalition, Washington, DC*
- *Phyllis Elkind, San Diego County Health and Human Services Agency, San Diego, CA*
- *Nancy Bryant Wallis, Family Health Centers of San Diego, San Diego, CA*
- *Carol Wilkins, Corporation for Supportive Housing, Oakland, CA (Moderator)*

Domestic Violence: Improving Responses, Expanding Options

Executive Center I

Families fleeing domestic violence may turn to homeless shelters when other options are unavailable, yet family shelters often lack expertise to provide appropriate supports. This workshop will explore how providers can enhance the services they offer to survivors and facilitate partnerships with domestic violence providers.

- *Maureen Friar, Consultant, Ardmore, PA (Moderator)*
- *Anna Melbin, National Network to End Domestic Violence, Washington, DC*
- *Gael Strack, National Family Justice Center Advance, San Diego, CA*
- *Susan Williams, U.S. Department of Justice Office of Violence Against Women, Washington, DC*



Engaging Foundations

Marina 6

From funding new models to increasing efforts to integrate homeless services with other systems, foundations are making investments to help end family homelessness. Speakers will discuss the strategy behind their funding decisions and what organizations can do to increase their funding.

- *Don André, Champion Foundation, Seattle, WA*
- *Robert Hobler, Melville Charitable Trust, Boston, MA*
- *Joseph Weisbord, Fannie Mae, New York, NY (Moderator)*
- *David Wertheimer, Bill and Melinda Gates Foundation, Seattle, WA*

From Top to Bottom: Planning a Family Homelessness System

Executive 3A & 3B

The ten year planning process requires that communities reevaluate how they use their homeless assistance resources. This workshop will use exercises and discussion to help participants answer these questions. How much emergency shelter do we need? How many units of transitional and permanent supportive housing are necessary? What kinds of housing subsidies and services are needed? What outcomes should we measure? And how do we put that all together?

- *Tom Albanese, Abt Associates, Gahanna, OH*
- *Norm Suchar, National Alliance to End Homelessness, Washington, DC (Moderator)*

Housing First/Rapid Re-Housing for Families

Seabreeze

Most families who experience homelessness can quickly move back into housing with the appropriate help. Speakers will provide examples of their work, including: intake and assessment, home-based case management, rent assistance, and building better relationships with landlords. Discussion will include how a community develops a vision and strategies, offering examples from communities in three different stages of development.

- *Jamey Burden, National Alliance to End Homelessness, Washington, DC (Speaker/Moderator)*
- *Greg Morris, City of Boise, Boise, ID*
- *Carol Walter, Connecticut Coalition to End Homelessness, Hartford, CT*
- *Marge Wherley, Hennepin County Human Services, Minneapolis, MN*

Permanent Supportive Housing for Families

Spinnaker

Permanent supportive housing ends homelessness for families with the most severe barriers to housing stability. Speakers will describe strategies for bringing family permanent supportive housing to scale and ensuring that it targets families who need the most intensive services in order to stay housed.

- *Joyce Crum, San Francisco Human Services Agency, San Francisco, CA*
- *Clare Nolan, Harder and Company, San Francisco, CA*
- *Steven Shum, Corporation for Supportive Housing, Oakland, CA (Moderator)*
- *Cindy Ward, San Francisco Human Services Agency, San Francisco, CA*

The Intersection of Child Welfare and Homelessness

Marina 2

Child welfare involvement and homelessness often intersect when families experience a housing crisis or when youth age out of foster care. This workshop will feature up-to-date research on the child welfare and homelessness connection and federal policies to solve this. Transition of youth who age out of foster care will have a particular emphasis. It will also examine collaborations that reduce family separation and homelessness.

- *Mark Courtney, Partners for Our Children, Seattle, WA*
- *LaKesha Pope, National Alliance to End Homelessness, Washington, DC (Moderator)*
- *John Wagner, California Department of Social Services, Sacramento, CA*



3:45 pm-4:00 pm: Break

4:00 pm-5:30 pm: Workshops III

Engaging Local and State TANF Agencies

Marina 2

TANF agencies provide an array of resources that support low-income families, which may include eviction prevention and rent assistance. Speakers will describe the strategies that two TANF agencies are using to meet the needs of families experiencing or at risk of homelessness and explore how practitioners can facilitate partnerships with their state and local TANF programs.

- *Stephanie Brown, Department of Transitional Assistance, Boston, MA*
- *Richard Glickstein, Human Resources Administration, New York, NY*
- *Sharon McDonald, National Alliance to End Homelessness, Washington, DC (Moderator)*
- *Sara Zuiderveen, Department of Homeless Services, New York, NY*

Future of Federal Policy for Homeless Families

Executive 2A & 2B

Congress is working on reauthorization of HUD's McKinney-Vento Homeless Assistance programs. Now with a new Administration comes the possibility of significant changes to homeless assistance policy. This session will be a discussion of the direction of homelessness policy and its possibilities for ending family homelessness.

- *Mark Johnston, U.S. Department of Housing & Urban Development, Washington, DC*
- *Norm Suchar, National Alliance to End Homelessness, Washington, DC (Speaker/Moderator)*

Getting on the Same Page: Systems Change

Spinnaker

Ending family homelessness requires system-wide change in the delivery of homeless assistance. This workshop will help providers, state and local officials, advocates, funders, and system-level planners address this challenge.

- *Elizabeth Benito, City of Chicago, Chicago, IL*
- *Louis Chicoine, Tri-City Homeless Coalition, Fremont, CA*
- *Sharon Rappport, Corporation for Supportive Housing, Los Angeles, CA (Speaker/Moderator)*

Harm Reduction and Family Well-Being

Marina 6

A harm reduction approach seeks to support and stabilize families who have members struggling with active substance use and addiction in housing while promoting sobriety and the safety of children. Speakers will discuss the operation of harm reduction programs for families and review strategies for protecting children.

- *Matthew Doherty, Corporation for Supportive Housing, San Diego, CA*
- *Phyllis Gilberti Chamberlain, Virginia Coalition to End Homelessness, Arlington, VA (Moderator)*
- *Erika Silver, Human Solutions Inc., Portland, OR*
- *Ed Stellan, Heartland Alliance, Chicago, IL*

Preventing Family Homelessness

Seabreeze

Communities are gaining a clearer picture of how families become homeless. This workshop will examine strategies that have worked to reach precariously-housed families before they enter shelter, through outreach to at-risk families, shelter diversion, and partnerships with providers serving low-income families.

- *Steve Berg, National Alliance to End Homelessness, Washington, DC (Moderator)*
- *Melissa Mowery, CAMBA, New York, NY*
- *Phyllis Ryan-Jackson, Philadelphia Committee to End Homelessness, Philadelphia, PA*
- *Matt White, Abt Associates, Columbus, OH*



Short-Term and Shallow Rental Subsidies

Executive 3A & 3B

Housing subsidies are a critical part of ending family homelessness. Cities and states have adopted a variety of rental assistance programs including short-term and shallow rent subsidies. Speakers will discuss their experiences with designing, implementing, and funding these programs.

- *Lindy Gill, Hamilton Family Center, San Francisco, CA (Moderator)*
- *Brian Greenberg, Shelter Network, Burlingame, CA*
- *Tiffany Kingery, Multnomah Department of County Human Services, Portland, OR*
- *Eileen Lynch, Department of Homeless Services, New York, NY*

Young Homeless Families: Serving the Entire Family

Executive Center I

Providers, advocates, and funders are exploring how to adapt homeless services to appropriately respond to the developmental needs of young mothers and their children. Speakers will discuss how they have tailored their interventions to improve services and outcomes for young families.

- *Mindra Fox, Reuben Lindb Family Services, Minneapolis, MN*
- *Meghan Henry, National Alliance to End Homelessness, Washington, DC*
- *Debra Medeiros, National Center on Family Homelessness, Newton, MA (Moderator)*
- *Laura Page, Antelope Valley Partners for Health, Lancaster, CA*

Facilitated Discussion: Leadership Challenges and Opportunities

Marina 3

This session is designed for public sector leaders at the state and local level who are shepherding their community’s efforts to end homelessness. This facilitated discussion will allow leaders to share with one another the challenges and opportunities they are encountering and the strategies they are undertaking to ensure ongoing progress.

- *Nan Roman, National Alliance to End Homelessness, Washington, DC (Facilitator)*

5:45 pm-7:00 pm: Reception with cash bar

Outdoor Lenai Area

CONFERENCE AGENDA | FRIDAY, FEBRUARY 13

8:00 am-1:00 pm: Registration

Harbor Island Foyer

8:00 am-9:00 am: Continental Breakfast

Harbor Island Foyer

9:00 am-10:30 am: Workshops IV

Assessment and Targeting: Matching Families with Resources

Executive 2A & 2B

Communities have a range of initiatives to end family homelessness including prevention, rapid re-housing, and transitional and permanent supportive housing. Speakers will examine strategies to help match families with the right intervention and discuss the steps necessary to develop and implement an assessment and targeting strategy.

- *Norm Suchar, National Alliance to End Homelessness, Washington, DC (Moderator)*
- *Tina Patterson, The Other Place, Dayton, OH*
- *Suzanne Wagner, Center for Urban and Community Services Housing Resource Center, New York, NY*



Federal Policy to End Family Homelessness

Executive 3A & 3B

Many communities have taken up the challenge of ending family homelessness, but accomplishing their goals requires a stronger federal response to their housing and services needs. Speakers will provide an update on current federal policies and new resources available for ending family homelessness as well as unveil priorities for the Congress and Administration.

- *Steve Berg, National Alliance to End Homelessness, Washington, DC (Speaker/Moderator)*
- *Danna Fischer, National Low Income Housing Coalition, Washington, DC*

Improving Child Outcomes

Marina 6

Children experiencing homelessness have health, development, and educational needs that are too often overlooked. Speakers will examine how partnerships with child-focused agencies can offer consistency and support to children as they transition from homelessness to housing in the community.

- *Peggy Bailey, National Alliance to End Homelessness, Washington, DC (Moderator)*
- *Samuel Girguis, Children's Health Hospital of Los Angeles, Los Angeles, CA*
- *Susan Reyna-Guerrero, Beacon Therapeutic and Diagnostic Treatment Center, Chicago, IL*
- *Laurel Weir, National Law Center on Homelessness and Poverty, Washington, DC*

Prevention: Building a Coordinated Response

Executive Center I

Communities often have numerous programs that help to prevent family homelessness including legal aid, faith-based, and emergency assistance programs. Speakers will examine how communities can provide more comprehensive and accessible assistance to at-risk families by improving coordination across programs.

- *Jamey Burden, National Alliance to End Homelessness, Washington, DC (Speaker/Moderator)*
- *Ji-Young Choi, Minnesota Housing, St. Paul, MN*
- *Michael Piepsny, Cleveland Tenants Organization, Cleveland, OH*
- *Beth Stokes, Hamilton Family Center, San Francisco, CA*

Responding to Increases in Family Homelessness

Seabreeze

Current economic conditions can further strain the budget of low-income families, causing increased family homelessness and greater demand for homeless prevention and shelter. This workshop will examine what communities that are experiencing increases in family homelessness are doing to meet this challenge within the context of ending family homelessness.

- *Hannah Cohen, Heritage Clinic, San Diego, CA (Moderator)*
- *Robert Hess, Department of Homeless Services, New York, NY*
- *Marge Wherley, Hennepin County Human Services, Minneapolis, MN*

Supporting Parents with Mental Health Disabilities

Marina 2

Parents experiencing homelessness may struggle with diagnosed and undiagnosed mental health issues, such as depression, anxiety disorders, post-traumatic stress disorder, and cognitive disabilities. Workshop speakers will explore mental health disabilities that are common to parents who experience homelessness and how providers can improve services and outcomes for these families.

- *Stephanie Hartsborn, Corporation for Supportive Housing, Chicago, IL (Moderator)*
- *James Lepanto, Mental Health Systems, Inc., San Diego, CA*
- *Andrew Sperling, National Alliance on Mental Illness, Arlington, VA*
- *Diana Waugh, National Alliance on Mental Illness - In Our Own Voice Living with Mental Illness, San Diego, CA*



Preventing and Ending Family Homelessness in Rural Communities

Marina 3

Rural communities face unique challenges to ending family homelessness. This workshop will address some of the major obstacles and how rural communities are overcoming them. Speakers will examine funding sources and discuss how to target resources to end family homelessness.

- *Jonda Clemings, Coalition on Homelessness and Housing in Ohio, Columbus, OH*
- *David Pollack, ICF International, Lexington, MA (Moderator)*
- *Annette Rodriguez, Yakima Neighborhood Health, Yakima, WA*

Working with Landlords

Spinnaker

In communities that employ rapid re-housing strategies, providers find that strong and lasting relationships with landlords overcome many of the barriers to housing that a family may experience. This workshop will discuss strategies for reaching out to and creating relationships with landlords that help families get into housing and maintain housing stability.

- *Samantha Batko, National Alliance to End Homelessness, Washington, DC (Moderator)*
- *Christine Mirasy-Glasco, Beyond Shelter, Inc., Los Angeles, CA*
- *Kay Moshier McDivitt, County of Lancaster, Lancaster, PA*

10:30 am-10:45 am: Break

10:45 am-12:15 pm: Workshops V

Emergency Shelter and Interim Housing

Executive 2A & 2B

Even as communities work to end homelessness, emergency shelter plays a critical role. Speakers will describe emergency shelter and interim housing models that facilitate rapid re-housing while meeting the safety needs of families.

- *Tom Albanese, Abt Associates, Gahanna, OH (Speaker/Moderator)*
- *Elizabeth Benito, City of Chicago, Chicago, IL*

Engaging your Public Housing Agency

Marina 2

Partnering with a public housing agency (PHA) is a critical strategy for creating permanent housing opportunities. Speakers will present ideas and strategies for working with PHAs. Workshop participants will have an opportunity to share ideas for engaging PHAs as partners in the Continuum of Care process.

- *Kerry William Bate, Housing Authority of County of Salt Lake, Salt Lake City, UT*
- *Samantha Batko, National Alliance to End Homelessness, Washington, DC (Moderator)*
- *Ruth Schwartz, Shelter Partnership, Inc., Los Angeles, CA*

Partnering with Community-Based and Faith-Based Organizations

Executive Center I

Community and faith-based organizations provide a range of services to low-income and homeless families including emergency assistance, case management, employment, and support services. This workshop will examine how facilitating partnerships with community-based and faith-based organizations can leverage new resources and supports to meet the needs of homeless families.

- *Mary Case, St. Vincent de Paul Village, San Diego, CA (Moderator)*
- *Sue Marshall, The Community Partnership for the Prevention of Homelessness, Washington, DC*
- *Kay Moshier McDivitt, Community Homeless Advisor for Lancaster County, Lancaster, PA*



Service-Intensive Interventions: Targeting and Design

Marina 6

Within and across homeless assistance programs, providers are experimenting with more intensive service strategies for families with the greatest needs. This workshop will examine the emerging models and how these interventions are being targeted to improve family outcomes.

- Jennifer Ho, *Hearth Connection, St. Paul, MN (Speaker/Moderator)*
- Ranita Jain, *Building Changes, Seattle, WA*
- Emily Nolan, *Building Changes, Seattle, WA*
- John Selfridge, *The Road Home, Salt Lake City, UT*

Substance Use Treatment: Useful Tools for Providers

Executive 3A & 3B

This workshop will explore the merits and challenges of various substance use treatment models, emphasizing how to help people who recognize that they need treatment but have not been able to achieve sobriety. Workshop speakers will focus on the cycle of recovery, ways to engage people with substance use challenges, and others issues.

- Lynne Appel, *Southern California Alcohol and Drug Programs, Inc., Downey, CA*
- Susan Bower, *County of San Diego Alcohol and Drug Services, San Diego, CA*
- Elizabeth Stoltz, *Southern California Alcohol and Drug Programs, Inc., Downey, CA*
- Deborah Werner, *Advocates for Human Potential, Topanga, CA (Speaker/Moderator)*

Systems-Level Performance Measurement

Seabreeze

Is your community successfully meeting the needs of homeless families? Homeless Management Information Systems (HMIS) can be used to measure system-level outcomes. This workshop will cover the basics of performance measurement at the systems level. Speakers will discuss how to use HMIS-based performance measures to support local planning efforts.

- Mary Cunningham, *Urban Insite, Washington, DC (Moderator)*
- Matthew Simmonds, *Simtech Solutions, Inc., Canton, MA*
- Brooke Spellman, *Abt Associates, Chicago, IL*

Transitional Housing

Spinnaker

As communities incorporate rapid re-housing and permanent supportive housing programs, they often find a need to refine the role of transitional housing. This workshop will examine how some communities have modified the way they employ their transitional housing resources through more strategic targeting, mission modification, and conversion to permanent supportive housing and transition-in-place models.

- Martha Burt, *Urban Institute, Washington, DC*
- Devra Edelman, *Hamilton Family Center, San Francisco, CA*
- Sharon McDonald, *National Alliance to End Homelessness, Washington, DC (Moderator)*
- Jennifer Pasinosky, *Superior Court of California, San Francisco, CA*

Facilitated Discussion: State and Local Change Agents

Marina 3

This interactive session is dedicated to state and local advocates who are promoting both policy and practice shifts in their communities to facilitate progress in ending homelessness. The discussion will focus on how to translate lessons across communities.

- Phyllis Gilberti Chamberlain, *Virginia Coalition to End Homelessness, Arlington, VA (Facilitator)*

12:30 pm-2:00 pm: Lunch/Plenary/Keynote

Harbor Island II and III

- Keynote Speaker Introduction: *The Honorable Mike Lowry, Co-Chair, National Alliance to End Homelessness, Renton, WA*
- Lynn Rosenthal, *Executive Director, New Mexico Coalition Against Domestic Violence, Albuquerque, NM*
- Conference Closing and Reflection: *Sharon McDonald, Senior Policy Analyst, National Alliance to End Homelessness, Washington, DC*



2:15 pm-3:30 pm: Workshops VI

Getting Better Outcomes from Your Continuum of Care

Executive Center 1

This workshop will help participants use the Continuum of Care (CoC) process to end family homelessness.

Speakers will describe how to integrate the CoC within a community's plan to end homelessness. They will discuss how to maximize the amount of resources received through the CoC while transitioning to a housing first approach.

- *Liz Drapa, Corporation for Supportive Housing, Chicago, IL*
- *Piper Ehlen, HomeBase, San Francisco, CA*
- *Chuck Kieffer, Washtenaw Housing Alliance, Ann Arbor, MI (Speaker/Moderator)*

Managing and Building Political Will

Marina 6

Ending family homelessness requires buy-in from the public, private, and nonprofit sectors. Speakers will discuss strategies for identifying community champions, communication strategies, and marketing ideas for building the case for ending family homelessness.

- *Richard Bloom, PATH (People Assisting the Homeless), Los Angeles, CA*
- *Damien Heath, National Alliance to End Homelessness, Washington, DC (Moderator)*
- *Sharan London, Montgomery County Coalition for the Homeless, Rockville, MD*
- *Lloyd Pendelton, Department of Community and Economic Development, Salt Lake City, UT*

Voluntary Case Management

Spinnaker

Interest in voluntary models of case management is growing with the increased use of rapid re-housing and permanent supportive housing models. Presentations, followed by small group discussions, will focus on engagement strategies and the organizational shift needed to serve families through a voluntary approach.

- *Anna Melbin, National Network to End Domestic Violence, Yarmouth, ME*
- *Ed Stellon, Heartland Alliance, Chicago, IL*
- *Andrea White, Center for Urban Community Services, New York, NY*
- *Aisha Williams, National Alliance to End Homelessness, Washington, DC (Moderator)*

Working with Undocumented Families

Marina 3

Undocumented families often face challenges accessing programs that would end their homelessness. Legal experts will describe the services that undocumented families are eligible for including special program provisions available to refugees and survivors of domestic violence.

- *Tanya Broder, National Immigration Law Center, Los Angeles, CA (Speaker/Moderator)*
- *Cecelia Levin, National Law Center on Homelessness and Poverty, Washington, DC*

Facilitated Discussion: New Resources in Economic Recovery Legislation

Seabreeze

The American Recovery and Reinvestment Plan before Congress is expected to provide an array of new funding that can be used to prevent and end family homelessness, including \$1.5 billion for prevention and rapid re-housing services.

This facilitated discussion will explore how participants are preparing to maximize the use of available resources.

- *Steve Berg, National Alliance to End Homelessness, Washington, DC (Facilitator)*



PLENARY SPEAKER BIOGRAPHIES

Mike Lowry was elected to the King County Council in 1975, and four years later began serving in the US House of Representatives. Upon taking office in 1993, as Washington's twentieth governor, Governor Lowry encouraged new businesses to locate in the state, expanded international trade, and steered the state out of a one and a half billion dollar deficit. Governor Lowry's balanced approach to government helped business prosper while protecting the environment and increasing education, health, social service and housing funding. He now heads Washington Agricultural Families Assistance (WAFA) with a major focus on Farmworker Homeownership. He is co-chair with former Governor Dan Evans of the Washington Wildlife and Recreation Coalition and co-chair with Susan Baker of the National Alliance to End Homelessness.

Sharon McDonald is a Senior Policy Analyst at the National Alliance to End Homelessness. Ms. McDonald focuses on policy and program strategies to address family homelessness. Prior to joining the Alliance, she was a direct practitioner in a Richmond, VA community-based service center for people who are homeless for nearly seven years. Ms. McDonald has experience providing service-enhanced housing in a subsidized housing development for low-income families with children and in housing for people living with HIV/AIDS. She served as a Social Work Congressional Fellow in Senator Paul D. Wellstone's office where she focused on welfare and housing issues. Ms. McDonald has been a Licensed Clinical Social Worker since 1991 and holds a Ph.D. in Social Work and Social Policy from Virginia Commonwealth University.

Nan Roman, President and CEO of the National Alliance to End Homelessness, is a leading national voice on the issue of homelessness. The Alliance is a public education, advocacy, and capacity-building organization with a network of over 7,000 nonprofit and public sector agencies and corporate partners around the country. Under Ms. Roman's leadership, the Alliance has developed a pragmatic plan to end homelessness within ten years. To implement this plan, she works closely with members of Congress and the Administration, as well as with cities and states across the nation. She collaborates with Alliance partners to educate the public about the real nature of homelessness and successful solutions. Ms. Roman has researched and written on the issue, is frequently interviewed by the press, and regularly speaks at events around the country. Her unique perspective on homelessness and its solutions comes from over twenty years of local and national experience in the areas of poverty and community-based organizations.

Lynn Rosenthal has 25 years experience working in women's services as an advocate, administrator, and organizer. She served for 6 years as Executive Director of the National Network to End Domestic Violence in Washington, DC. In this capacity Ms. Rosenthal lobbied Congress on the Violence Against Women Act and built corporate partnership addressing domestic violence. She served previously as consultant for the Florida Coalition against Domestic Violence working on housing and economic justice and as a battered women's shelter director. Currently Ms. Rosenthal serves as Executive Director of the New Mexico Coalition against Domestic Violence.

Jerry Sanders is the 34th Mayor of San Diego. Since being elected to office, Mayor Sanders has been implementing a series of reforms to make the City more efficient and accountable. He is dedicated to community involvement, open government, and returning the City to a sound financial footing with the capability of meeting all of its municipal responsibilities. Over the course of his 30-year career, Mayor Sanders has proven skillful at transforming organizations so that they become more effective and efficient. He served as San Diego's Chief of Police from 1993 until 1999, capping a 26-year career with the Police Department. After leaving the Police Department, Mayor Sanders became the CEO of United Way, taking over an organization that had lost some of the trust of its donors and the agencies it supported. He slashed bureaucracy, restored the organization's effectiveness, and increased fundraising by almost 20 percent. As Mayor, he is applying his experience and skills to transform City government.



WORKSHOP SPEAKER BIOGRAPHIES

Tom Albanese has provided planning, development, implementation, and management support for housing and homeless programs since 1992 and presently provides consulting and technical assistance services as an Associate with Abt Associates, Inc. Mr. Albanese previously served as the Director of Programs and Planning for the Community Shelter Board (CSB) in Columbus, Ohio and was responsible for homeless and housing program research, development, and technical assistance. He formerly served as the Associate Director of a diverse family services agency, where he had major program and administrative responsibilities for the agency's homeless services, mental health, and community programs. He served as the director of an emergency shelter for single adults and families and as founding director of a 75 unit transitional housing program recognized as a best practice by HUD and the State of Ohio. Mr. Albanese received his undergraduate degree in sociology from Kent State University and is a Licensed Social Worker in Ohio.

Don André ensures that the Campion Foundation's programs and activities are supported through the organization's infrastructure and operational plans, and also serves as lead staff for the homelessness program. Mr. André comes to the Foundation after serving for three years as executive director of Northwest Sustainable Energy for Economic Development (Northwest SEED), a nonprofit organization advancing energy efficiency and renewable energy across the Northwest. Before that, he worked for more than 20 years with the Spokane Neighborhood Action Programs (SNAP), where he designed, implemented, and administered a wide range of low-income housing and energy programs. Don is currently Washington Caucus Chair of the Northwest Energy Coalition.

Lynne Appel is currently the Executive Director of Southern California Alcohol and Drug Programs, Inc. (SCADP Inc.). SCADP is a large multi faceted agency serving men, women and children with over 500 residential beds in Los Angeles and Orange Counties. She is active in a number of national, state, and local organizations that work in the areas of homelessness, substance abuse, and mental health. She is currently the co-chair of the California Association of Perinatal Treatment Providers (CAPTN) as well as an adjunct college instructor in the area of psychology and chemical dependency. Ms. Appel has a Master's Degree from Indiana University in Counselling Psychology and a Professional Certificate in Gerontology. She has lectured nationally and internationally for the National Institute of Drug Abuse and the State Department.

Peggy Bailey is a Health Policy and Program Analyst for the National Alliance to End Homelessness. She works with mental health and substance abuse treatment providers to ensure they fulfill their role in preventing homelessness and allow homeless individuals to access services. Prior to joining the Alliance, Ms. Bailey worked on healthcare financing and service delivery issues for the Association of Maternal and Child Health Programs. She is a graduate of the University of Notre Dame and has a Masters Degree in Public Affairs from the University of Texas at Dallas. She previously worked for the City of Rockwall, TX as an assistant to the Director of Public Works and later the Assistant City Manager. Upon moving to Washington, DC in 1999, she was an advocate for the land grant university system, which receives funds from the US Department of Agriculture to conduct agriculture research and provide outreach services to farmers and the community.

Barbara Banaszynski serves as the National Director of Program Development for Volunteers of America. Ms. Banaszynski assists Volunteers of America affiliate agencies to review local human service needs and to plan and implement community-based solutions for persons who are veterans, homeless, have formerly been incarcerated, or who experience mental illness or mental retardation or other disabilities. She has over 20 years experience in the management of nonprofit agencies meeting the needs of marginalized individuals and families. Ms. Banaszynski serves on committees and/or the the Board of Directors of several local nonprofit organizations, including Coalition for the Homeless, Metropolitan Housing Corporation, Interagency Council on the Homeless, and the Housing and Homeless Coalition of Kentucky.



Kerry William Bate, a former Utah state employee, is now director of the Salt Lake County Housing Authority. He is the past chair of the Salt Lake County Homeless Coordinating Council. He was instrumental in establishing the state's Homeless Coordinating Committee in 1987. Mr. Bate has been one of the leaders in Utah's effort to address homelessness, including building permanent supportive housing and working with state and county leaders to establish new rental subsidy programs to help this population. He is the recipient of Utah Issues' "Bureaucrat of the Year," YCC's "Courage to Care Award," and Utah's "Manager of the Year" in 2000. A graduate of Weber State College (1972), he was a Fannie Mae Fellow at Harvard University's "Senior Executives in State and Local Government Program" in 2002.

Samantha Batko, Capacity Building Associate for the Center for Capacity Building at the National Alliance to End Homelessness, helps state and local governments, communities, and nonprofit programs implement plans to prevent and end homelessness. The Center for Capacity Building also provides specific technical assistance and training for communities and organizations implementing Housing First. Ms. Batko joined the Alliance in February 2006 as the Communications Associate. As the Communications Associate, she edited the online newsletter and managed the website in addition to developing fact sheets, reports, and other educational materials. Prior to working for the Alliance, she worked for a crisis hotline while obtaining her BS in Psychology from Virginia Tech. While in high school, Ms. Batko worked with the Carpenter Shelter in Alexandria, VA, providing food for homeless families.

Elizabeth (Betsy) Benito is with the newly established Chicago Department of Family and Support Services. She serves as the Project Director for the Plan to End Homelessness and is responsible for the day-to-day management of the Plan's implementation. This involves system planning, policy and project development, and coordinating with other public and private stakeholders. Prior to joining the City of Chicago in 2005, Ms. Benito worked on Chicago's Plan while serving as the Associate Director of the Partnership to End Homelessness, now the Chicago Alliance to End Homelessness, a collaboration of homeless service providers in Chicago. She also has experience in community organizing, community-based research, and philanthropy. Ms. Benito holds a Masters in Social Service Administration from the University of Chicago, and a BS in Social Work from Loyola University Chicago.

Steve Berg, Vice President for Programs and Policy at the National Alliance to End Homelessness, specializes in employment, economic development, and human services, as well as the crossover between those issues and housing. He came to the Alliance from the Center on Budget and Policy Priorities, where he worked on state-level welfare reform and employment. Before coming to Washington, Mr. Berg spent 14 years as a legal services attorney in California and Connecticut, working on housing, government benefits, employment, and family integrity. His experience includes nonprofit management and staff training and development.

Nancy Bernstine has served as executive director of the National AIDS Housing Coalition since October 2003. From 1986-1993, she was a member of a Washington, DC law firm representing nonprofit housing organizations and housing industry trade associations. From 1993-1999, Ms. Bernstine served as Director of Government Relations for the National Housing Law Project, providing back up services for legal services housing advocates. As Senior Policy Associate at the McAuley Institute from 2000-2003, she provided policy analysis on issues impacting community based organizations developing affordable housing. A member of the District of Columbia Bar and the American Bar Association Affordable Housing Forum and a graduate of Northwestern University School of Law and the LLM program at the University of Wisconsin Law School, Ms. Bernstine serves on the board of the National Low Income Housing Coalition and is a trustee of the National Housing Conference.



Richard Bloom became Executive Director of Community Initiatives for PATH (People Assisting the Homeless) in Los Angeles, California in November 2008. With a national reputation for innovation developed over 25 years, PATH tapped him to be responsible for coordinating and leading initiatives that are designed to expand political and public will to end homelessness in Los Angeles. Mr. Bloom is also an attorney and consultant in private practice with nearly 30 years of experience providing family law. He is the former Executive Director of Levitt & Quinn Family Law Center in Los Angeles, California, a nonprofit law firm serving low-income clients. Mr. Bloom has served as a Judge Pro Tem and volunteer mediator for the Los Angeles Superior Courts and on the Executive Committee of the Los Angeles County Bar Association Family Law Section. He received a Bachelor's degree in Communications and Public Policy at the University of California, Berkeley.

Susan Bower has been in the alcohol and drug treatment field for 20 years, working with pregnant and parenting women and youth, in the prevention field, and in the justice arena. She was involved with the implementation of the Adult Drug Court system in San Diego, as well as the planning and implementation of Proposition 36. Ms. Bower is currently the Deputy Director of Alcohol and Drug Services, overseeing all initiatives and contracted community prevention activities along with treatment and recovery services for youth and adults throughout the County.

Tanya Broder, an attorney at National Immigration Law Center (NILC), focuses primarily on analyzing the ways in which federal, state, and local governments have been implementing the welfare and immigration laws passed in 1996. She writes articles and policy analyses, provides technical assistance, co-counsels litigation, and presents trainings to legal and social service providers, legislative staff, and community-based organizations. Before joining NILC in 1996 she worked as a policy analyst for the Northern California Coalition for Immigrant Rights and as a staff attorney for the Legal Aid Society of Alameda County in Oakland. Ms. Broder holds a JD from Yale Law School.

Richard Brown has thirty-five years experience in both housing development and the management of affordable housing. Since 1991 he has been the Chief Executive Officer of Monarch Housing, the 1995 Governor's Excellence in Housing Award winner in the organization category. Monarch Housing's vision is that every person will have quality, affordable, permanent housing that fosters freedom, independence, and community integration. In addition, Mr. Brown is the chairperson of the New Jersey Advocacy Network to End Homelessness.

Stephanie Brown has been the Director of Housing and Homeless Services at the Massachusetts Department of Transitional Assistance (DTA) since October 2007. Her division is responsible for the Commonwealth's \$130 million individual and family shelter systems and the federal Continuum of Care and Emergency Shelter Grants administered by the state. Ms. Brown came to DTA to transform the family homelessness system away from shelter and into a system that focuses on prevention, stabilization, economic stability, and access to permanent housing families can afford. Prior to coming to DTA, Ms. Brown was the executive director of Homes for Families, a statewide advocacy organization working to end family homelessness. Before joining the HFF team in 2003, Ms. Brown managed domestic and sexual violence policy and programs for the Massachusetts Executive Office of Health and Human Services. She is a long-time board member and volunteer at the Boston Area Rape Crisis Center.

Jamey Burden is the Assistant Director of the Center for Capacity Building at the National Alliance to End Homelessness. He is helping to lead the Alliance's efforts to strengthen the capacity of communities, states, and faith- and community-based organizations to end homelessness. Prior to working with the Alliance, Mr. Burden worked with the Minnesota Housing Finance Agency, directing the state's Family Homelessness Prevention and Assistance Program. He also served on Minnesota's Interagency Task Force on Homelessness, addressing policy issues such as state coordination of homelessness assistance funding, Continuum of Care planning, and statewide HMIS implementation. MR. Burden has worked on homelessness and housing services programs and advocacy for 14 years including planning and advocacy work with the Connecticut Coalition to End Homelessness and direct-service work at family a homeless shelter. He has an MSW from the University of Connecticut



Martha Burt is the Director of Social Services Research Program at the Urban Institute. Since 1983, she has been involved in policy research and evaluation related to homelessness. Her current and recent work includes a study of life after transitional housing for families in five communities; an evaluation of efforts to reduce homelessness among seriously mentally ill people in Los Angeles; and family permanent supportive housing in San Francisco. Dr. Burt recently completed *Changing Homeless Mainstream Service Systems: Essential Approaches to Ending Homelessness*, an invited review for the Second National Symposium on Homelessness Research. She has also recently written guides for conducting cost avoidance analyses and projecting from point-in-time to annual homeless counts for the Corporation for Supportive Housing. In 1987 Dr. Burt directed the first national survey of homeless individuals.

Phyllis Gilberti Chamberlain is the Executive Director of the Virginia Coalition to End Homelessness (VCEH). In this role, Phyllis advocates for change in policy and programs to end homelessness in the Commonwealth of Virginia and provides information on the causes of and solutions to homelessness. She manages all aspects of the organization including advocacy and policy development, program initiatives, membership, finance and fundraising. Prior to VCEH, Phyllis served as the Director of Field Mobilization for the National Alliance to End Homelessness where she assisted local organizations to build political will among Members of Congress on issues such as appropriations funding for the Departments of Housing and Urban Development (HUD) and Health and Human Services (HHS), the reauthorization of the McKinney-Vento Homeless Assistance Grants Program, and the National Housing Trust Fund. Phyllis is a board member of New Hope Housing which provides housing and services to individuals and families experiencing homelessness in Fairfax County, Virginia.

boona cheema has served as the Executive Director of Building Opportunities for Self-Sufficiency (BOSS), an Alameda County organization dedicated to fighting homelessness, for over 30 years, having worked her way up after first entering as a client in 1971. For nearly four decades, she has focused on building new resources for homeless and poor people, integrating the voice and involvement of homeless people in decisions and policies intended to serve them, and working at the local, state, national, and international levels to support civil rights and social justice. In addition to her role in BOSS, Ms. cheema has served as Board Member, volunteer, consultant, and trainer for numerous organizations serving poor families and youth, including the Encampment for Citizenship, Sports4Kids, First Fund for Youth, and others.

Ji-Young Choi is the Family Homeless Prevention and Assistance Program (FHPAP) Manager at Minnesota Housing Finance Agency. Prior to joining the agency, she has directed a homeless family shelter at Catholic Charities for three years, and she has managed Housing, Workforce Development, Transportation, and Return on Investment Programs at Greater Twin Cities United Way for two years. Ms. Choi holds two Masters degrees in Business Management and Adult Education from Iowa State University. She is originally from South Korea and came to U.S. for higher education in 1998. Ms. Choi used to be a documentary film writer and producer in Korea and produced about 100 films during her five years at Korean Broadcasting System. She loves reading and traveling to explore different cultures and people's lives.

Jonda Clemings joined the Coalition on Homelessness and Housing in Ohio (COHHIO) as the Rural Housing Program Coordinator in May 2007. This position at COHHIO provides technical assistance and capacity building to rural Ohio – specifically around 10 Year Plans to End Homelessness, Continuum of Care, and other rural housing and homelessness issues. Ms. Clemings received her Masters of Education in Social Agency Counseling II from University of Dayton and BA in Psychology from Ashland University. Previously, she was the Housing Coordinator at Moundbuilders Guidance Center a comprehensive community mental health agency for five years. Ms. Clemmings also worked for The Main Place, a consumer oriented mental health recovery center assisting with their development of service-enriched housing. She was an active representative on the Emergency Needs Coalition of Knox County and the Licking County Housing Initiatives, local continua of care groups, serving as chair and secretary of both groups.



Marilyn Cornell is the Clinical director at Veterans Village of San Diego, a residential treatment facility for homeless veterans with substance abuse and other disorders. She supervises clinical interns and trainees and oversees the clinical needs of the Veterans Recovery Center and the Welcome Home Family Program which serves homeless veterans and their families. Ms. Cornell is a member of the San Diego Regional Task Force on the Homeless, the Psych-Law Society of San Diego, and the Homeless Court Alliance. She has volunteered at Stand Down in San Diego for the past twenty years as a tent leader. Ms. Cornell has worked as a Mental Health Consultant at Rachel's Womens' Center and as a probation officer for San Diego County.

Mark Courtney is Executive Director of Partners for Our Children (POC), a public-private partnership at the University of Washington devoted to improving child welfare services. He is also the Ballmer Chair for Child Well-Being in the School of Social Work at the University of Washington. He previously served on the faculties of the University of Chicago, where he was Director of the Chapin Hall Center for Children, and the University of Wisconsin-Madison. Much of Dr. Courtney's research has focused on child welfare services and policy. His current work includes experimental evaluation of independent living services for foster youth and evaluation of Solution-Based Casework as a child welfare practice model. Dr. Courtney obtained his MSW and Ph.D. degrees from the School of Social Welfare at the University of California at Berkeley. Before moving into academia, he worked for several years in various capacities providing group home care to abused and neglected adolescents.

Joyce Crum is the Director of Housing and Homeless Programs at the San Francisco Human Services Agency. She manages the City's emergency shelter system and Housing First Programs. She has served on several taskforces coordinating the city's multi-faceted, interagency approach to homelessness and related housing policy. Ms. Crum has worked in the field of social work for over thirty years. She is a former high school English teacher, Director of Welfare to Work, and Coordinator of the STEP School to Career for the San Francisco Private Industry Council. She completed her graduate work at Michigan State University and undergraduate work at Eastern Michigan University. Ms. Crum is a recipient of the SF Human Services Commission, employee of the month for her contribution to the development of the Care Not Cash welfare program for the City and County of San Francisco.

Dennis Culhane's primary area of research is homelessness. He is currently working with several states and cities on interventions to prevent family homelessness.

Mary Cunningham is a Senior Research Associate in the Metropolitan Housing and Communities Center at the Urban Institute. She has over ten years of experience in qualitative and quantitative research and evaluation, project management, program and policy development, and technical assistance. Her research focuses on homelessness, housing, concentrated poverty, and efforts to improve family self-sufficiency and overall well-being among low-income families. Prior to joining the Urban Institute, Ms. Cunningham launched and directed the Homelessness Research Institute, the research and education arm of the National Alliance to End Homelessness. While directing the Homelessness Research Institute, she worked to build the intellectual capital around solutions to homelessness and to advance data and research so that policymakers, practitioners, and the public have the best information about trends in homelessness and evidence-based programs and policies.

Matthew Doherty, Director, Resource Center, joined the Corporation for Supportive Housing (CSH) in October 2002. Prior to his position as Director, he was a Senior Program Manager within CSH's Project Development and Finance team, and he first joined CSH as the lead Program Officer for San Diego County. Mr. Doherty has a Master of Public Administration from the University of Washington and has more than 17 years of experience in the coordination of supportive service programs for low-income communities and people with disabilities, including substance abuse intervention, advocacy, case management, refugee services, and educational programming. Prior to joining CSH, Mr. Doherty managed the Resident Services Department of the San Diego Housing Commission. He was previously the Assistant Director of Resident Services for the King County Housing Authority in Seattle, WA.



Gail Dorfman was first elected to the Hennepin County Board of Commissioners in 1999. She currently serves as Chair of the Board's Health and Human Services Committee. Commissioner Dorfman has made ending homelessness her top priority. She established the Community Advisory Board on Homelessness, brought Project Homeless Connect to Minneapolis, and co-chaired the Commission to End Homelessness, creating the ten-year plan, "Heading Home Hennepin." Commissioner Dorfman oversaw a 43 percent reduction in family homelessness in Hennepin County and developed new county affordable housing programs that have funded 96 housing projects over the past eight years. Commissioner Dorfman received the 2008 Public Sector Achievement award from the National Alliance to End Homelessness. Prior to her election to the County Board, she served as the Mayor of St. Louis Park. She holds a BA from the Ohio State University and an MPA from Harvard's Kennedy School of Government.

Liz Drapa, Associate Director with the Corporation for Supportive Housing (CSH) Illinois, works with organizations to strengthen their capacity to build and operate supportive housing. She has over ten years of experience working with housing and special needs populations. Ms. Drapa's work at CSH focuses on public policy at the City and State levels, administering the Supportive Housing Institute, and providing technical assistance to providers across the State. Prior to joining CSH, she worked with the Chicago Continuum of Care on Chicago's 10 Year Plan and as a consultant for HUD, focusing on AIDS housing and homelessness issues.

Devra Edelman has worked with Hamilton Family Center (HFC) for four years in the roles of Director of Programs and Program Director for Hamilton Family Transitional Program (HFTP). At HFTP, she has worked closely with San Francisco's Collaborative Justice System to coordinate services with the Dependency Drug Court and Behavioral Health Court. Prior to working at HFC, Ms. Edelman served as the Executive Director of the Haight Ashbury Food Program. She has also worked with the Gathering Place, Theodora House (Volunteers of America) and the Women's Bean Project in Denver, CO and within the international development field in South and Central America and Africa. Ms. Edelman has an MSW and Masters of International Studies from the University of Denver.

Piper Ehlen is a staff attorney at HomeBase in San Francisco. For the past seven years she has specialized in Continuum of Care work, drafting and implementing ten year plans to end homelessness, and providing technical assistance. Ms. Ehlen's recent experience includes: convening and facilitating Contra Costa's Ten Year Plan to End Homelessness implementation group; designing and implementing a comprehensive program for outreach/engagement, mental health drug treatment, supportive housing, and wrap-around supportive services for chronically homeless in Contra Costa; Continuum of Care strategic planning research and project development in numerous communities and providing technical assistance to grassroots and faith-based groups in the Bay Area. Prior to joining HomeBase, Ms. Ehlen worked as a Law Clerk at the U.S. Environmental Protection Agency and the Sierra Club.

Phyllis Elkind coordinates Maternal, Child, and Family Health Services for the County of San Diego Health and Human Services Agency. Ms. Elkind has more than 20 years of experience providing public health services and programs in State, County, and local health agencies.

Danna Fischer is Legislative Director and Counsel for the National Low Income Housing Coalition. Before joining the Coalition, she was a Senior Director at Freddie Mac where she was responsible for the company's relationship with the Department of Housing and Urban Development. Danna got her start in housing policy as counsel to the Housing Subcommittee of the House Committee on Banking, Finance, and Urban Affairs (now the House Committee on Financial Services). On the committee, she worked on a wide range of housing issues, including the development of the HOME program, housing preservation, McKinney revisions, Section 8 reauthorizations, and public housing.



Mindra Fox is the Intake/Services Coordinator for the STRong: Strengthening Our New Generation Program at Reuben Lindh Family Services. She has worked in early childhood education for over 17 years. During her past 7 years at Reuben Lindh, Ms. Fox has worked in the Multicultural Therapeutic preschool, Court ordered Supervised Visitation program, Family Partnership program, and the HOPE program, and, she now manages the STRong program. Ms. Fox was, herself, a young mother and her history includes experiences with homelessness and chemical dependency.

Maureen Friar is currently a consultant to nonprofit organizations and has over 15 years experience in the field of supportive housing. From 2006-2008, she worked with National Equity Fund, the largest nonprofit investor of federal low-income housing tax credits nationally. For 13 years Maureen served as Executive Director of the Supportive Housing Network of New York, a coalition of not-for-profit agencies that develop and manage affordable housing with on-site supportive services for low income and formerly homeless adults and families. She was involved in several campaigns in New York City and statewide to increase the stock of supportive housing with the ultimate goal of ending homelessness. Ms. Friar earned her AB at Brown University and a Masters in Public Policy at the University of California at Berkeley. She was a 1999-2000 Charles H. Revson Fellow on the Future of the City of New York at Columbia University.

Lindy Gill, the First Avenues Program Director, began her at Hamilton Family Center in the summer of 2006 during the inception of the First Avenues Program: *Housing Solutions for Families*. Since that time she has been involved in developing and implementing their Shallow Rental Subsidy Program. Ms. Gill sets the programs' goals and objectives in accordance with varying clients' needs and manages the Housing Specialist and Home-Based Support Services each family receives in First Avenues.

Samuel Girguis is a Clinical Psychologist in the outpatient mental health trauma clinic (Project Heal) at the University of Southern California/University Center for Excellence in Developmental Disabilities program at Children's Hospital Los Angeles. His clinical training and practice has focused on providing therapy to children and families who have been exposed to different kinds of trauma: physical abuse, sexual abuse, domestic violence, etc. Dr. Girguis has been providing on-site services to Good Shepherd Center for Homeless Women and Children in Los Angeles since 2006. His services include individual trauma-focused therapy, trauma-focused children's group therapy, parenting support, family therapy, and consultation with Good Shepherd staff. Dr. Girguis has presented his work with homeless women and children at the American Psychological Association's Annual Conventions and at the Annual International Conference on Violence, Abuse, and Trauma.

Richard Glickstein is the Executive Director, Homelessness Prevention, of the Office of Housing and Homeless Services of the New York City Human Resources Administration (HRA). The Office of Housing and Homeless Services has staff located throughout the City who help families maintain stable and affordable housing and avoid eviction and placement in the City shelter system. Mr. Glickstein has been with HRA for eight years and, prior to his current position, served as a policy consultant in the areas of housing, cash assistance, food stamps, and welfare reform generally. He is a graduate of Harvard Law School and practiced law for over twenty years prior to joining HRA.

Brian Greenberg is a licensed psychologist and Director of Programs at Shelter Network. Prior to working in homeless services, Dr. Greenberg developed and administered drug treatment program for almost 20 years.



Kathleen Guarino is a Project Manager and Trauma Specialist at the National Center on Family Homelessness. She assists in curricula and other material, and presentation development, as well as training and consultation around the effects of violence and trauma in the lives of children and families. Ms. Guarino managed the development of the Trauma-Informed Organizational Toolkit and currently oversees its implementation at the local and national level, providing training, education, and consultation to create trauma-informed programming in shelter and housing programs. Her previous experience includes working as a clinician in a residential treatment facility and providing therapeutic services for children and families impacted by trauma. Ms. Guarino is a licensed mental health clinician who received her Master's in Counseling Psychology from Boston College in 2001. She continued her clinical training by completing the Certificate Program in Traumatic Stress Studies at the Trauma Center in Brookline, MA, in 2007.

Thomas Hameline oversees program development and program design for HELP USA, a nonprofit organization based in New York City. He has developed and overseen the implementation of new residential facilities, homeless prevention programs, vocational training programs, and a fair housing center for the agency. Dr. Hameline serves as the Co-Director of HELP's Fresh Start for Families project, an inter-agency collaboration with the Ackerman Institute for the Family and City College of New York that provides family support services to homeless families. Before joining HELP USA, Dr. Hameline was a supervising psychologist and a member of the psychology training faculty at the Jewish Board for Family and Children's Services in New York City. He is a licensed psychologist with post-doctoral certification in family and couples therapy from the Ackerman Institute; he has a bachelor's degree from Princeton University and a doctoral degree from the University of California, Berkeley.

Stephanie Hartshorn is a Senior Program Manager with the Illinois office of the Corporation for Supportive Housing (CSH). In this role, she works closely with the Illinois Division of Mental Health to increase the availability of permanent supportive housing for persons with serious mental illness. Prior to joining the CSH Illinois office, Ms. Hartshorn worked with CSH in Michigan and with the Policy and Research Unit in CSH's Washington, D.C. office. Before coming to CSH, she was the Housing Coordinator for the Shelter Association of Washtenaw County where she administered the agency's Shelter Plus Care program. Ms. Hartshorn also worked in various capacities with the Washtenaw Housing Alliance on its efforts to implement the ten-year plan to end homelessness in Washtenaw County. She has a bachelors degree in Psychology from the University of Michigan as well as an MSW and Masters of Business Administration from that University.

Damien Heath is the Director of the Center for Capacity Building at the National Alliance to End Homelessness. He leads the development and implementation of the Alliance's efforts to strengthen the capacity of local communities, states, and faith and community based organizations to end homelessness. Prior to joining the Alliance and the Center for Capacity Building, Mr. Heath worked in the nonprofit sector providing training and technical assistance for over 10 years. In that time he trained hundreds of organizations, foundations, and government agencies on a variety of programmatic and organizational topics. Mr. Heath has led or played a significant role in the management and execution of 10 national capacity building initiatives that have directly impacted over 1000 unique nonprofit organizations across the country.

Meghan Henry is a Research Associate at the National Alliance to End Homelessness. Joining the staff in July 2006, she is responsible for analyzing various data and research on homelessness, writing research reports and briefs, monitoring progress on the Ten Year Plan, and connecting policymakers with research on homelessness. Ms. Henry graduated from Tufts University with her Masters degree in Urban and Social Policy and Planning in May 2006. While pursuing her Masters degree, she worked at a substance abuse clinic and as a Research Assistant at Tufts University in the field of Urban Economics. Prior to graduate school, Ms. Henry was a researcher for special projects at US News and World Report. She has a bachelors degree from the University of Florida.



Robert Hess is currently Commissioner of the New York City Department of Homeless Services under Mayor Michael R. Bloomberg. As Commissioner, he leads a more than 2,000 member staff dedicated to overcoming the experience of homelessness for the men, women and children of New York City. Prior to being appointed Commissioner, Mr. Hess spent five years as a member of the administration of Philadelphia Mayor John F. Street, serving as the Deputy Managing Director for Special Needs Housing. His accomplishments in Philadelphia include leading the development and implementation of the City's 10-year, \$10 million plan to end homelessness and dramatically reducing the number of people experiencing homelessness. He was previously with the Center for Poverty Solutions, the Maryland Food Committee, and Action for the Homeless. He played a key role in the start-up of the Maryland Center for Veteran Education and Training, serving as President and CEO, and also worked his way up to Executive Director of Economic Enterprises during a 16 year stint with the Disabled American Veterans of Maryland.

Jennifer Ho is the Executive Director of Hearth Connection, which manages a network of supportive housing providers helping people with long histories of homelessness to find stability, recovery, and prosperity. Covering 26 counties, Hearth Connection has advocated for and manages state supportive services funding and state and federal rental assistance. Since 2001, over 2,000 people have benefited, including 380 families with over 750 children. Hearth Connection's programs also target single adults and unaccompanied youth. Prior to joining Hearth Connection in 1999, Ms. Ho was Vice President of product development in United Health Group's AARP division and managed government programs at Blue Cross and Blue Shield of Minnesota. She is on the Board of the Corporation for Supportive Housing. She has a bachelor's degree in philosophy from Bryn Mawr College.

Robert Hohler is the Executive Director of the Melville Charitable Trust, a foundation dedicated to finding and supporting solutions to end homelessness. For almost two decades, he has helped develop pioneering funding initiatives and mission-related investments in supportive and affordable housing and community development. As Chair of the Executive Committee for Funders Together, Mr. Hohler leads a national effort to mobilize philanthropic leadership to change systems and create innovative approaches to end homelessness. He also chairs the Board of the Partnership for Strong Communities, the Connecticut-based education and advocacy program of the Trust. Mr. Hohler currently serves as an advisor to the Public Charities Division of the Massachusetts Attorney General and is on the board of Connecticut Council for Philanthropy. He is also on the Film and Media Archive advisory board of the Washington University in St. Louis and the National Council of Washington University Libraries.

Alfreda Iglehart is Vice Chair and an Associate Professor in the Department of Social Welfare in the UCLA School of Public Affairs. Her research addresses the effects of changing social environments on social service delivery systems and processes and diverse communities. One aspect of Dr. Iglehart's work addresses the history and development of social service interventions with diverse clients. As part of this focus, she is studying the organization, structure, and service delivery patterns of human service programs and agencies. Dr. Iglehart seeks to identify those policies and practices that facilitate service delivery to diverse populations and promote inter-organizational relationships. The other aspect of her work addresses the needs of and services to adolescents who age-out of, or emancipate from, foster care. Dr. Iglehart received a BA in Sociology from St. Mary's University, an MSW from Our Lady of the Lake University, and a Ph.D. in Social Work and Sociology from the University of Michigan.

Ranita Jain joined Building Changes in March 2008. She manages the monitoring and evaluation efforts for Building Changes programs. Ms. Jain has eight years of extensive experience with survey development and data management systems. Prior to joining Building Changes, she was the Senior Research Associate for New York City's Department of Social Services, Office of Evaluation and Research. One of Ms. Jain's responsibilities was managing a performance measurement system which assessed community-based organizations in providing employment, job-retention, and barrier removal services for welfare clients. She also worked as a management consultant for PricewaterhouseCoopers advising in process development and analytical design and for technology projects.



Sarah Kahn is the Director of Field Mobilization with the National Alliance to End Homelessness. She advocates in collaboration with the Alliance's local, state, and national partners for the advancement of policies and programs that promote permanent solutions to homelessness. In this position, Ms. Kahn assists in managing legislative campaigns and instructs advocates in building and strengthening relationships with elected officials. Prior to working with the Alliance, she assisted in the coordination of the Continuum of Care processes at the Homeless Services Coalition of Greater Kansas City Missouri while working toward an MSW in Social Work from the University of Kansas.

Kate Kelly manages Reaching Home, the campaign to end long-term homelessness in Connecticut through the creation of 10,000 new units of supportive housing in the next 10 years. She also coordinates the Partnership for Strong Communities' federal advocacy efforts to end homelessness. Prior to joining the Partnership in July 2003, Ms. Kelly was the executive assistant to Hartford City Councilman Robert Painter. She holds a BA in government with a concentration in public policy from the University of Notre Dame and an MSW in Social Work, concentrating in Community Organization and Policy & Planning, from the University of Connecticut School of Social Work. Ms. Kelly and her husband live in Farmington, CT.

Chuck Kieffer is the Executive Director of the Washtenaw Housing Alliance, a unique non-profit responsible for implementing Ann Arbor/Washtenaw County's "10-Year Plan to End Homelessness." Dr. Kieffer is also an Adjunct Lecturer in Psychology and Social Work at the University of Michigan, and is the principal of Crest Avenue Collaborations, LLC, a private consulting firm specializing in organizational planning and community resource development. From 1999-2006, he served as Homeless Programs and Policy Administrator with the Michigan State Housing Development Authority. In this position, he acted as MSHDA's lead policy and planning specialist in the areas of homelessness, human services, and special needs housing. Dr. Kieffer is an honors graduate of Yale University (BA, 1974) and received his doctorate in Psychology and Education at the University of Michigan (Ph.D., 1981).

Tiffany Kingery has worked to end homelessness in Multnomah County for the past six years. Previously, Tiffany worked as an activist and educator on the topics of sexual assault, domestic violence and women's empowerment. Tiffany has a degree in Women Studies from the University of California at Santa Barbara. Presently Tiffany works for Multnomah County in Portland, OR doing planning and program development work with a focus on ending homelessness and poverty.

James Lepanto is Vice President of the Family Services Division of San Diego based Mental Health System, Inc. (MHS). MHS is a nonprofit organization with over 100 programs dedicated to improving lives in the communities it serves through the prevention, education and treatment of mental health and alcohol and drug related issues. Mr. Lepanto oversees MHS's children's mental health and alcohol and drug programs in a variety of innovative service delivery models. In addition to his position within MHS, he is a licensed Marriage and Family therapist, motivational speaker and community advocate with over 29 years of experience working with high risk youth and their families. Mr. Lepanto has specialized in the areas of trauma, child abuse, and victims of crime and post-traumatic stress. He has worked in a variety of capacities as a therapist, clinical director, administrator, program director, media consultant and educator.

Cecelia Friedman Levin is currently the domestic violence staff attorney at the National Law Center on Homelessness and Poverty (NLCHP). Prior to joining NLCHP, Ms. Levin worked as an Immigration Staff Attorney at Ayuda, a nonprofit legal and social service provider assisting the low-income immigrant community in the Washington, D.C. area. Her work particularly focused on asylum, removal proceedings, and relief for survivors of domestic violence, human trafficking, and other violent crimes. She has also worked at the D.C. Bar Pro Bono Program Law Firm Clinic and participated in the D.C. Law Students in Court program representing low-income tenants in landlord-tenant court. Before law school, Ms. Levin worked as a Fulbright Research Scholar in Santiago, Chile assessing community responses to domestic violence. She received her BA in International Studies and Women and Gender studies from American University and her JD from American University-Washington College of Law.



Sharan London is the Executive Director of the Montgomery County Coalition for the Homeless, a position she has held since 1996. In this capacity she directed the establishment of the Safe Havens program, oversaw the expansion of emergency shelter for men from an overnight trailer to a 24 hour a day, 9500 square foot state of the art facility with vocational training and a medical clinic, and leads advocacy efforts on behalf of the homeless men, women and children in our community. Ms. London was instrumental in the development of the Partnership for Permanent Housing, a housing first program for families and singles. In addition to her role as Executive Director, she is the President of Coalition Homes, Inc., an affiliate of MCCH created to own and operate housing. Coalition Homes currently owns 42 units of housing and is completing the acquisition of a building for conversion to 32 units of permanent supportive housing.

Eileen Lynch is Executive Director of Management Analysis and Quality Assurance in the Division of Policy and Planning for the New York City Department of Homeless Services (DHS). She oversees the unit that provides analytical support to DHS in meeting its strategic goals, researching trends in homelessness and their causes, and evaluating the effects of departmental policies. In addition, the unit produces public data on trends in homelessness for the agency. Ms. Lynch joined DHS in 2004 as Special Assistant to the Deputy Commissioner of Policy and Planning and has also served as Director of Strategic Planning and Special Initiatives where she was the project manager for the implementation of Advantage New York, DHS' portfolio of rental assistance programs. Prior to coming to DHS, Ms. Lynch worked for Good Shepherd Services, a youth development and child welfare organization. She holds a BA in Economics from Boston College and an MPA from New York University's Wagner School of Public Service.

Sue Marshall is the founding Executive Director of The Community Partnership for the Prevention of Homelessness, a public/private partnership in D.C. The Community Partnership works to foster local neighborhood initiatives to resolve chronic community problems, including homelessness. Ms. Marshall has provided technical assistance in the areas of homeless continuum of care development and implementation, development of plans to end homelessness, and replication of D.C.'s model Community Care Grant Program. She also has an extensive history of public service, including 8 years as the Vice Chair of the District of Columbia Housing Finance Agency. She has served as Chief of Staff of the DC Department of Human Services, Mayor's Homeless Coordinator, Staff Economist to the DC Council Committee on Finance and Revenue, Urban Policy Analyst for the Department of Housing and Urban Development and housing market analyst for the Urban Institute.

Sharon McDonald is a Senior Policy Analyst at the National Alliance to End Homelessness. Ms. McDonald focuses on policy and program strategies to address family homelessness. Prior to joining the Alliance, she was a direct practitioner in a Richmond, VA community-based service center for people who are homeless for nearly seven years. Ms. McDonald has experience providing service-enhanced housing in a subsidized housing development for low-income families with children and in housing for people living with HIV/AIDS. She served as a Social Work Congressional Fellow in Senator Paul D. Wellstone's office where she focused on welfare and housing issues. Ms. McDonald has been a Licensed Clinical Social Worker since 1991 and holds a Ph.D. in Social Work and Social Policy from Virginia Commonwealth University.

Debra Medeiros is a Project Director at the National Center on Family Homelessness, overseeing Strengthening At Risk and Homeless Young Mothers and Children, a multi-year Initiative of the Conrad N. Hilton Foundation. She was previously the Senior Program Officer at the Greater Worcester Community Foundation. Ms. Medeiros has worked for a variety of healthcare and higher education institutions and was a Peace Corps Volunteer in the Dominican Republic. She has a bachelors of Business Administration from George Washington University and a Masters of Public Administration from New York University.



Anna Melbin is the Housing Specialist at the National Network to End Domestic Violence Fund. In this position she provides technical assistance to transitional housing programs across the country, focusing on services for survivors of domestic, sexual and dating violence, and stalking. Ms. Melbin has worked with and on behalf of homeless families and domestic violence survivors for 15 years. She began providing direct services in homeless shelters, as an advocate in a battered women's shelter, and as a case manager in transitional housing programs for families. She then broadened her experience to state-level and national work. Prior to joining NNEDV Fund, Ms. Melbin worked for the Michigan Domestic Violence Prevention and Treatment Board (MDVTPB). Ms. Melbin holds a Masters of Social Work and a Masters of Public Policy, from the University of Michigan, Ann Arbor.

Christine Mirasy-Glasco is the Executive Director/COO of Beyond Shelter, a nonprofit organization founded in 1988 that aims to develop systemic approaches to combat poverty and homelessness among families with children and enhance family economic security and well-being through various programs, notably the "Housing First Program." Prior to joining Beyond Shelter, she led the Contracts and Grants Management department of the Los Angeles Homeless Services Authority (LAHSA), a joint powers authority of the City and County of Los Angeles whose mission is to plan, coordinate, and implement initiatives to end homelessness in Los Angeles County. Ms. Mirasy-Glasco holds a bachelors degree in International Law from the University of Nice, Sophia-Antipolis, a Masters degree in International and European Law from the University of Paris II – Panthéon-Assas, and a Pre-doctorate degree in International Economic Law from the University of Paris I – Panthéon-Sorbonne.

Greg Morris graduated from Trinity University in 1993 with a BA in Political Science and Speech Communication. From 1992-2000, he coordinated federally funded programs for at-risk and troubled youth in Fort Worth, TX. Upon moving to Boise in 2001, Mr. Morris supervised the Hays Shelter Home for runaway and homeless youth, and then managed the Community House Homeless Shelter for the City of Boise. He currently manages Project CATCH (Charitable Assistance to Community's Homeless), a community-wide collaborative effort between local government, congregations of faith, and area businesses. CATCH rapidly re-houses homeless families with children and supports them for up to six months with rental assistance and case management. CATCH was recently honored by the National League of Cities with the Silver Award for Municipal Excellence. Mr. Morris also currently serves as the City of Boise's ADA/Fair Housing Coordinator.

Kay Moshier McDivitt is the Community Homeless Advisor for Lancaster County, a new position created in January 2009 to oversee the County's Continuum of Care Planning process and to provide leadership for the newly-released Heading Home: Lancaster 10 Year Plan to End Homelessness. Prior to this, she served as Vice President for Programs for Tabor Community Services Inc., a community based organization committed to ending homelessness. During her 12 years at Tabor, she oversaw a number of initiatives, including the Shelter to Independent Living Program, a housing first program established in 1988, Rental Counseling to Prevent Homelessness, and other model housing programs geared toward ending homelessness. She has provided community leadership since 1994 as an active member of the Lancaster Interagency Council on Homelessness as the current co-chair of the Continuum of Care and Advocacy Subcommittee and was actively involved in the development of the County's 10 Year Plan to End Homelessness.

Melissa Mowery has over 20 years of experience working in the social services field with diverse populations. She has coached Special Olympians, worked with mentally ill adults and juvenile offenders, and worked on workforce development and vocational training with Asylees, Refugees, and those receiving public benefits. For the past 5 years, Ms. Mowery has been the Program Director for CAMBA's HomeBase, a homelessness prevention program funded by the Department of Homeless Services in New York City. This program provides rapid housing, aftercare, and prevention services to those families and adults most likely to enter shelter. It offers support and the knowledge needed to keep households stable and strong. This program was designed by Mayor Bloomberg's Administration to confront the assumption that homelessness was simply a fixture of urban life.



Clare Nolan has more than ten years of experience designing and conducting evaluation, research, and technical assistance projects for nonprofits, philanthropy, and government. Her work is focused primarily on homelessness, vulnerable children and youth, grantmaker effectiveness, and organizational capacity-building. Ms. Nolan has completed several evaluations of programs for homeless individuals and families, including a study regarding the effectiveness of permanent supportive housing for homeless families in San Francisco. She received her Masters degree from the Goldman School of Public Policy at University of California, Berkeley in 2003. Ms. Nolan is Vice President of Harder+Company Community Research, a California-based consulting firm that specializes in research and planning for the social sector.

Emily Nolan has over 12 years of experience in the housing and homelessness fields. She currently manages the day-to-day operations of the Washington Families Fund (WFF). Ms. Nolan provides assistance and guidance to both WFF grantee agencies and potential applicants. As Supervisor of the Community Information Line of King County she helped connect clients with appropriate services and provided trainings to service providers on how best to link clients with resources. Her past experience also includes providing direct service to youth transitioning out of the juvenile justice and foster care systems and working on affordable homeownership issues for Washington residents. Ms. Nolan has developed and provided numerous trainings to consumers and housing professionals on topics such as: how to navigate the shelter system and finding affordable housing. She has a BA in Sociology from Washington State University and an MA in Organizational Management from the University of Phoenix.

Laura Page is an Early Interventionist at Antelope Valley Partners for Health, a community collaborative promoting health and wellness in the Antelope Valley area of northern Los Angeles County. She is currently working on the Strengthening Young Families program, a mobile community partnership offering services to marginalized young mothers and their children. Ms. Page has diverse experience in early childhood and elementary development. She received Early Childhood and Administration certification from UCLA, and has a BA from CSU, Long Beach. Ms. Page has 10 years experience working with children, infant through 8th Grade, including 3 years supporting students with special needs. Her primary goal is and always has been to encourage and promote success in young children.

Jennifer Pasinosky is the Program Manager of the San Francisco Superior Court's Dependency Drug Court, a court-supervised substance abuse treatment and parenting program for adults with children involved in the juvenile dependency (or child welfare) system. Since 2002, she has worked to implement and strengthen collaborative justice programs within the court system, including the Adult Drug Court and Behavioral Health Court. In her current capacity, Ms. Pasinosky works closely with several community-based service providers to achieve a common mission: long-term family stability. She has a Masters in Public Policy from the University of Michigan's Ford School of Public Policy.

Tina Patterson is Executive Director of The Other Place (TOP), a nonprofit agency in Dayton, Ohio that works to end homelessness. Over the past decade, she has led TOP's evolution from an emergency daytime shelter to a multi-faceted, proactive agency that serves adults and families at all points in the continuum of homelessness, including prevention, street outreach, case management in shelter, and supportive services in transitional and permanent housing. Ms. Patterson has served as a consultant to several of the surrounding rural counties in developing their own Continuums of Care and she also served on the Corporation for Supportive Housing's Strategic Committee and on the board of the Coalition on Homelessness and Housing in Ohio. Ms. Patterson holds a BS in Human Services Management from Urbana University.



Lloyd Pendleton is presently employed by the State of Utah in the Division of Housing and Community Development, Department of Community and Culture. He was a loaned executive from The Church of Jesus Christ of Latter-day Saints to the State of Utah in 2004 and 2005 to take the lead in writing the State's ten-year plan for ending chronic homelessness. Upon retiring from Church employment in early 2006, he was employed by the State of Utah to continue the implementation of the organization and systems to end chronic homelessness and reduce overall homelessness by 2014. Mr. Pendleton graduated from Brigham Young University with a bachelors degree in Political Science and a Masters in Business Administration. He worked for The Church of Jesus Christ of Latter-day Saints in the Welfare Department for 25 years where he was the controller of the Bishop's storehouses and canneries and managed several operational units.

Mike Piepsny was named Executive Director of the Cleveland Tenants Organization (CTO) in June, 2006. Prior to this position, he was the lead tenant organizer at CTO and a Rental Information Specialist. As the lead organizer, Mr. Piepsny was responsible for a 2004 voter participation drive that increased the voter turnout in twenty-five HUD subsidized buildings from 23% to 81%. He is a 1997 graduate of the Cleveland Marshall School of law and has held internships at the Housing Advocates, Inc. and the U.S. Department of Justice. Mr. Piepsny has been a frequent local and national speaker on affordable housing issues and grassroots organizing strategies, and he has been a guest speaker and writer on nationally renowned television and print media, such as Bill Moyer's Journal and the National Tenants Voice.

David Pollack is a Fellow/Technical Director at ICF International. Before joining ICF International in 1998, he was Director of the Program Development Division in HUD's Office of Special Needs Assistance Programs with responsibility for developing HUD's McKinney-Vento homeless assistance programs, including SHP, Shelter Plus Care and ESG. He also played a key role in developing the Continuum of Care planning and application process. Since joining ICF, he has managed major homeless assistance technical assistance projects and program evaluations, as well as developing training workshops and direct technical assistance. He currently oversees all tasks under HUD-ICF McKinney-Vento CD-TA cooperative agreements. Mr. Pollack received a BS from the University of Wisconsin and a JD from the National Law Center, George Washington University.

LaKesha Pope is a Youth Policy and Program Analyst at the National Alliance to End Homelessness. Prior to joining the Alliance, Ms. Pope worked at Public Strategies, Inc. in government relations providing client support in the areas of media strategy, market research, project management and legislative affairs. She was also responsible for program development for various statewide Governors' Conferences for Women. Ms. Pope served two terms as the Points of Light Foundation Youth Engaged in Service Ambassador for Texas. As the youth spokesperson for the Texas Commission on Volunteerism and Community Service, she developed and facilitated trainings nationwide and managed a statewide youth service council that implemented thousands of volunteer service hours throughout Texas. She has a Masters of Public Affairs from the University of Texas Lyndon Baines Johnson School of Public Affairs with a Concentration in Nonprofit Management. While pursuing her graduate degree, Ms. Pope worked at the Children's Defense Fund, where she provided analysis of national and state policies on child and youth development. She received a BS in Business Administration with a concentration in Marketing from Xavier University in Louisiana.

Barbara Poppe, Executive Director (October 1995 - present) of the Community Shelter Board (CSB), has more than 20 years of non-profit experience in homelessness and housing related organizations. CSB is a nationally recognized non-profit organization that creates collaborations, innovates solutions, and invests in quality programs to end homelessness in Columbus and Franklin County, Ohio. She provides visible leadership in achieving community wide homeless services and prevention objectives. Ms. Poppe is responsible for strategic planning and collaborative efforts, private sector fundraising and resource development, effective governmental systems, and private sector relationships. From June 1990 to October 1995, she was the Executive Director of Friends of the Homeless, Inc. Ms. Poppe served as the principal investigator for two federal demonstration grants. She received the 2002 Citizen of the Year Award from the Central Ohio Public Relations Society of America. Ms. Poppe earned an MS in Epidemiology from the University of Cincinnati.



Robert Pulster currently serves as Executive Director of the Interagency Council on Housing and Homelessness, which is charged with the implementation of the Massachusetts Commission Plan to End Homelessness. Prior to this position, Mr. Pulster was the Executive Director of the Ecumenical Social Action Committee (ESAC) where he developed the Sustainable Homeownership Center. Before going to ESAC, Mr. Pulster worked at the South Middlesex Opportunity Council as Director of the Framingham Resource Center, overseeing shelter and homeless prevention programs. He is currently the Board's Vice President for the Family to Family Project in Boston, which provides grant assistance to homeless families and those at risk of homelessness. A graduate of Framingham State College, Mr. Pulster has a Masters degree from the McCormack Institute in Public Affairs at UMass Boston.

Sharon Rapport joined the Corporation for Supportive Housing (CSH) as Senior Program Manager for Policy and Planning in November 2006. At CSH, Ms. Rapport advances and coordinates efforts to implement a California policy agenda across multiple issues affecting people experiencing homelessness, including participating in the state's planning process to end long-term homelessness, working to enact measures to channel Medi-Cal resources toward more effective services for people experiencing homelessness and chronic illness, advocating for expedited processing of SSI cases for disabled homeless individuals, and engaging in efforts to create a state services funding program. Prior to joining CSH, Ms. Rapport served as a Congressional Fellow for U.S. Senator Jack Reed (D-RI), focusing on housing and judiciary issues. She earned an MFA from Antioch University, a JD from George Washington University, and a BA from the University of California, Los Angeles.

Annette Rodriguez serves as the Outreach Coordinator for Yakima Neighborhood Health Service. Ms. Rodriguez has worked with the Community Health Care center since 1991. She has been working with Yakima's Health Care for the Homeless program since 2005. Ms. Rodriguez supervises the Street team and housing specialist, as well as Yakima's newest program, Respite Care. Her goal is to coordinate and navigate clients through health care, housing, and entitlements.

Phyllis Ryan-Jackson graduated from the University of Iowa with a double major in art history and American history. She has lived and worked in the Philadelphia area since then, earning a living as a researcher and an advocate on poverty and women's issues. Ms. Ryan led efforts to produce a state and city study of homelessness in Pennsylvania in the late 1980's. She has produced numerous advocacy documents and campaigns. She treasures the independence and responsibility of private funding to work with and on behalf of Philadelphians who still have no place to call "home."

Jeff Schaffer, Southern California Director for Enterprise Community Partners, oversees Enterprise's technical assistance and training programs, policy work supporting affordable housing and community development, and lending activities. Prior to joining Enterprise, he served as Assistant Vice President for Grant Programs at the Conrad N. Hilton Foundation, where he managed a \$60 million grants portfolio including a \$10 million homeless initiative. In addition, Mr. Schaffer is a former associate director at both Beyond Shelter and Shelter Partnership in Los Angeles. He previously worked in state government, in the private sector in public relations, for the U.S. Congress and also served as a Peace Corps Volunteer in Micronesia. Mr. Schaffer earned an undergraduate degree from the University of California, Berkeley and a Masters degree in Public Administration from the University of Southern California, where he is a clinical assistant professor at the School of Public Policy, Planning and Development.

Ruth Schwartz is the founder and Executive Director of Shelter Partnership, Inc.; a unique nonprofit organization established in 1985 that develops strategic housing solutions and resources for Los Angeles County's growing homeless population. In 1991, it developed collaboratively with the Housing Authority of the City of Los Angeles (HACLA) the Homeless Section 8 Voucher Program, which now has more than 4,000 housing vouchers set-aside for homeless families and single individuals. Shelter Partnership's technical assistance efforts have resulted in more than a quadrupling of the short-term housing system, as well as the development of thousands of permanent housing units for homeless persons with special needs and families. Ms. Schwartz serves on the California Department of Housing and Community Development's Loan Advisory Committee and is a long-time member of the Los Angeles Emergency Food and Shelter Local Board.



John Selfridge is a Licensed Clinical Social Worker who received his undergraduate degree in Psychology from Virginia Tech in 1991 and his Masters degree in Social Work from Howard University in 1997. He began his career working with adjudicated youth and abused children in the Washington, D.C. area. In 1997, Mr. Selfridge moved to Salt Lake City, UT and started working at The Road Home Homeless Shelter as an Intensive Case Manager. Currently, he serves as the Director of Clinical Services at The Road Home, providing clinical support in shelter and to programs serving chronically homeless individuals and families who are housed in the community.

Alice Shobe joined Building Changes as its first Program Director of Homeless Families Initiatives in July 2008. Under her direction, Building Changes will significantly expand its activities focused on preventing homelessness, housing families more quickly, and building deeper connections between employment and housing systems in Washington State. Ms. Shobe brings 20 years of experience in housing, philanthropy, and community development to Building Changes. Prior positions include Director of Sound Families, CEO of Philanthropy Northwest, and Executive Director of the Washington Community Development Loan Fund. In 2007, she began her career as a City Planner with A Regional Coalition for Housing (ARCH) and the City of Kent, Washington. Ms. Shobe holds a BA in Urban Policy from James Madison College of Michigan State University.

Steven Shum is a Program Manager with the Corporation for Supportive Housing's (CSH) Northern California Office. He provides training, consulting and financial support to help communities create permanent housing with services to prevent and end homelessness. Mr. Shum serves as Co-Chair of the San Francisco Family Supportive Housing Network. Much of his work focuses on creating supportive housing opportunities for formerly homeless families, transition age youth, and single adults. Prior to joining CSH, Mr. Shum was a Senior Associate with ICF International where his work focused on affordable housing and social service opportunities for low income families and individuals. He also served as Planning and Development Associate for LifeLong Medical Care, a community health center that provides services to medically underserved people. Mr. Shum is a graduate of the masters program in City and Regional Planning at UC Berkeley.

Erika Silver has more than twenty years experience working with homeless families, including three in her current position as Director of Programs at Human Solutions in Portland, Oregon. She spent twelve years working with domestic violence survivors, including six as Executive Director of a local domestic violence agency. She has a Certificate in Non-Profit and Financial Management from Portland State University and developed the Homes Not Beds Family Collaborative, which is a successful harm reduction Housing First program for homeless families.

Matthew Simmonds is President of Simtech Solutions Inc. Simtech Solutions provides end-to-end services to homeless agencies, continuums, as well as the Commonwealth of Massachusetts to help these entities achieve and maintain compliance with mandated data collection standards while keeping these systems in line with the unique operational needs of each entity. Mr. Simmonds is the business architect for the Department of Transitional Assistance statewide HMIS system, SHORE, and leads the effort to consolidate the data from hundreds of agencies within the state into one reporting environment. Mr. Simmonds and the staff at Simtech Solutions also work with several agencies statewide to create customized data collection, data cleansing, and reporting systems that leverage the assets already made available within any HUD XML compliant HMIS application while meeting other reporting needs such as those for PATH and United Way.



Bob Snow is Senior Vice President for the National Affordable Housing Trust's (NAHT) development consulting group. The Trust is a nonprofit company that operates as an extension of its Members' National Church Residences, Volunteers of America, Retirement Housing Foundation, The Good Samaritan Society, and Mercy Housing Inc. NAHT provides financial and development resources that are "up streamed" to its members to support their affordable housing missions. Mr. Snow has more than 30 years of experience in housing. He directed the Property Management department for an Ohio based developer including residential, retail, and office properties, as well as rehabilitating and syndicating historic tax credit financed rental properties. Mr. Snow has been with NAHT for 18 years, having initially helped establish the asset management department and is currently responsible for the Trust's development-consulting group assisting with the origination, feasibility analysis, and development management on behalf of the Trust's members.

Brooke Spellman, Senior Associate with Abt Associates Inc., has fifteen years of experience in homelessness and community development issues. Ms. Spellman has a thorough understanding of homeless housing and service program models, the community systems for responding to homelessness, and the primary funding streams used to support homeless and mainstream housing and service programs. She regularly works with local communities to develop strategies to improve access to housing and services and to measure program and system-level performance. Ms. Spellman is presently the Director of a study for HUD's Office of Policy Development and Research on costs associated with homelessness. She is also very knowledgeable about homeless management information systems and other similar data sets and has worked with these data sets to understand patterns of homeless service utilization for research and policy purposes.

Andrew Sperling is Director of Legislative Advocacy for the National Alliance on Mental Illness—the largest national organization representing people with mental illness and their families. He also serves as a Co-Chair of the Consortium for Citizens With Disabilities Housing Task Force—a coalition of national disability groups that advocates for affordable housing opportunities for people with disabilities.

Ed Stellan is Director of Resource and Community Development for Heartland Health Outreach's (HHO) Mental Health and Addiction Services. Prior to this, he served as director of HHO's Pathways Home, a comprehensive continuum of residential and outpatient services for individuals who are homeless and have co-occurring mental health and substance use disorders. He has worked within the substance use and mental health treatment systems for more than eighteen years providing direct service as well as overseeing outreach, Assertive Community Treatment, and supportive housing programs. Mr. Stellan volunteers at Heartland's Marjorie Kovler Center where he provides counseling services to survivors of torture. He is committed to innovative service models that promote human rights and is a founding member of the Midwest Harm Reduction Institute.

Elizabeth Stoltz began working in social services teaching young men in the New York State Juvenile Justice System in 1997. She has been working with youth, women, and children in Southern California at Southern California Alcohol and Drugs Program, Inc. since 2003. Ms. Stoltz has a BS in molecular biology and an MFA in writing.

Norm Suchar is a Senior Policy Analyst at the National Alliance to End Homelessness with a focus on chronic homelessness. He joined the staff of the Alliance in 2002. Mr. Suchar promotes effective policies and practices related to supportive housing, mental health, substance abuse treatment, health care, and other services for homeless people as well as programs that facilitate rapid re-housing for families and individuals. His prior experience includes three years in the Budget Office at the U.S. Department of Housing and Urban Development, where he focused on homelessness and community development programs, and two years working in child welfare for the State of Utah.



Yasmin Tarver has over 15 years of experience advocating on behalf of women and families. She is currently the Director of Housing First & Employment Services Programs at Beyond Shelter in Los Angeles, CA. She has previously worked for the LA Works One-Stop Career Center in San Gabriel Valley, CA, where she assisted women and men transition from public assistance to employment, and for the 1736 Family Crisis Center, an LA-based nonprofit organization providing services to victims of domestic violence. Ms. Tarver holds a Masters Degree in Public Administration from California State University and a bachelors Degree in Sociology and Black Studies from the University of California.

Tanya Tull founded Beyond Shelter in 1988, introducing an innovation in the field—the “housing first” approach to ending family homelessness. She also founded Para Los Ninos (1980) in L.A.’s Skid Row; co-founded L.A. Family Housing Corporation (1983), which develops and operates emergency shelters, transitional and permanent housing; and founded A Community of Friends (1988), which develops permanent supportive housing for the chronically homeless mentally ill and other special needs populations. In addition to Housing First for Homeless Families, Beyond Shelter develops service-enriched, affordable housing in inner-city neighborhoods and, for the last decade, has been implementing a Neighborhood Revitalization Project in South L.A. Ms. Tull has a BA from Scripps College, teaching credentials from UCLA, and an Honorary Doctorate in Social Science from Whittier College.

Jamie Van Leeuwen completed his Ph.D. in Public Policy at the Graduate School of Public Affairs at the University of Colorado Denver with an emphasis on affordable housing and homelessness. He has a Masters degree in International Public Health and a Masters degree in Sociology from Tulane University. In 2006, he was appointed by Denver Mayor John Hickenlooper to work as the Project Manager for Denver’s Road Home, the city’s ten year plan to end homelessness. He currently oversees leadership staff, fundraising, public relations and evaluation for Denver’s Ten Year Plan to End Homelessness. In 2007, Mr. Van Leeuwen was appointed to chair the Drug Strategy Commission and oversee the Office of Drug Strategy. Prior to his role in the public sector, he directed fundraising, legislative work, and research as the Director of Development & Public Affairs at Urban Peak, a Colorado non-profit agency serving homeless and at-risk youth.

John Wagner was appointed director of the California Department of Social Services by Governor Arnold Schwarzenegger in April 2007. In California, he is moving his department in a new direction by setting policy to develop strategic and organizational performance metrics to help measure program performance and improve service delivery outcomes. With nearly two decades of experience in human services, he has served as senior policymaker and advisor to six gubernatorial administrations in Wisconsin and Massachusetts. Prior to his appointment, Wagner concurrently served in the Massachusetts Executive Office of Health and Human Services as Assistant Secretary for Children, Youth and Families and as Commissioner for the Department of Transitional Assistance. He was responsible for policy and program coordination between four state agencies, overseeing the administration of cash assistance, shelter, and food programs and reforming agency programs for homeless families including establishing individual self-sufficiency plans.

Suzanne Wagner is the Director of the CUCS Housing Resource Center, a national training, technical assistance and information program that seeks to increase access to housing for homeless, disabled and other low income people. Ms. Wagner has provided training and consultation to hundreds of nonprofit and public agencies throughout the country to expand their capacity to provide effective services and improve coordination among housing and service systems. She has also guided government agencies and community groups through planning processes to strategically allocate resources and close gaps in services. Ms. Wagner has more than twenty years of experience in the design and delivery of housing and service programs and holds an MSW from Columbia University and a bachelors degree from Barnard College.



Nancy Bryant Wallis has spent her more than 30 year professional career in the health care field, working in a variety of settings including hospitals, academia, and community health centers. With a doctorate in Public Health and a master's degree in Social Work, she has significant expertise in health care operations in staff, leadership, and consultant roles—working as a line staff clinical social worker, part-time college professor, and hospital and community health center administrator. At present, Dr. Wallis is Regional Director of Special Populations and Satellite Operations at Family Health Centers of San Diego, a large community health center system here in San Diego. She administers all of the agency's clinical and programmatic services for adolescents, public housing residents and the homeless; oversees multiple school-based and school-linked health service delivery systems; and facilitates the agency's mental health services, mobile medical units and its Medical and Healthy Families outreach and educational activities.

Carol Walter, Executive Director of the Connecticut Coalition to End Homelessness. She has worked throughout the state of Connecticut in the field of homeless services since 1987 as a service provider, manager, administrator, and community leader. She has operated shelter programs in New Haven, Stamford, Hartford, and East Hartford, created and implemented supportive housing programs in Hartford and East Hartford, served on the Board's of both the Connecticut Coalition to End Homelessness and the Connecticut AIDS Residence Coalition, and has worked extensively as a senior manager for a community action agency overseeing not only homeless programs but a myriad of ancillary anti-poverty programs such as employment, energy assistance, youth services, and neighborhood services. Since joining CCEH in 2006, she has worked to expand the agencies statewide role in promoting data driven solutions to homelessness in Connecticut.

Cindy Ward is the Manager of Family Services for the Housing and Homeless Programs at the San Francisco Human Services Agency, overseeing city-funded programs that serve homeless families, including rental assistance and prevention programs, emergency shelter, childcare, transitional housing, supportive services, and permanent supportive housing. She is the Chair of the FEMA/EHAP Local Board, as well as a Board member of Jelani, Inc., a nonprofit agency that provides residential substance abuse treatment for families. Previously, she had 17 years of experience in providing direct services to a wide range of populations, including battered women, teens in group homes, ex-offenders, addicted mothers and their children in residential treatment, and homeless families in emergency shelters. She graduated from the University of California at Davis with a degree in Women's Studies.

Diana Waugh brings 15 years experience as a Manager and Corporate Trainer to her work in the mental health field. She has presented workshops at National Alliance on Mental Illness (NAMI) State and National Conventions. She is currently a State Trainer and Coordinator for the NAMI program, In Our Own Voice, Living With Mental Illness. Ms. Waugh has been telling her story of recovery: her experience of homelessness and struggles and successes with Bi-Polar Disorder, PTSD, ADHD, and Panic Disorder since. She spoke before the Senate Committee in Washington, DC on Older Adult Depression, Suicide, and Violence in 2003. Ms. Waugh also spoke at the White House Commission on Mental Illness in San Diego in 2004. She talks about how untreated depression can kill as she shares her own story and the suicide of both parents on a DVD called "Not Just The Blues." Ms. Waugh has shared her story on radio and TV emphasizing that mental illness is an illness like any other and recovery is possible.

Laurel Weir is the Policy Director for the National Law Center on Homelessness & Poverty, where she has worked since 1989. Ms. Weir received her BA from Scripps College in Claremont, California and her Master's Degree in Public Policy from the University of Maryland at College Park. Ms. Weir conducts and oversees the Law Center's federal legislative and administrative branch advocacy, including advocacy to reauthorize and amend the McKinney-Vento Education for Homeless Children and Youth Program and the Child and Adult Care Food Program. She has served on numerous expert panels regarding homelessness and regularly presents at national, state, and local conferences about legislation and policies affecting homeless persons.



Joe Weisbord is Fannie Mae's Director, Homelessness Initiatives in the Housing and Community Development division. He leads Fannie Mae's initiatives to increase the supply of supportive and affordable housing for homeless individuals and families. Prior to joining Fannie Mae in January 2005, Mr. Weisbord served as staff director for Housing First!, a public education campaign promoting solutions to New York City's affordable housing shortage. Housing First! played a key role in shaping Mayor Michael Bloomberg's \$3 billion "New Housing Marketplace" initiative. Mr. Weisbord has over 25 years of experience in housing and community development, including six years with the Corporation for Supportive Housing. He began his career in the construction industry. Mr. Weisbord is on the faculty of the Graduate Center for Planning and the Environment at Pratt Institute.

Deborah Werner, has been engaged in efforts to improve substance abuse, domestic violence, public health, and homeless services for women, families, and communities since 1989. She has led training initiatives, provided strategic consultation to strengthen organizations, launched programs, advocated for improved policies, and delivered services. Ms. Werner serves as the Project Director for the Women, Children and Families Technical Assistance Project at Advocates for Human Potential, Inc. She is consulting with SAMHSA on several projects including: the development of behavioral health competencies for working with women and a national women's leadership institute. Ms. Werner's previous positions include serving as the Associate Director, at Beyond Shelter, Inc. and as the Executive Director of the California Women's Commission on Alcohol and Drug Dependencies.

David Wertheimer has worked in a variety of capacities in the nonprofit, government and philanthropic sectors for almost three decades. He currently serves as the Senior Program Officer for the Pacific Northwest initiative at the Bill & Melinda Gates Foundation in Seattle. He carries lead responsibilities for oversight of the foundation's programs addressing housing and family homelessness. Prior to assuming these responsibilities, Mr. Wertheimer served as Principal at Kelly Point Partners (KP2), an independent consulting firm he established in 2000 to promote integration of human service systems targeting persons struggling with homelessness, mental illness, addictions, criminal justice system involvement and HIV/AIDS. Between 1990 and 2000, Mr. Wertheimer served in King County, WA government developing, mobilizing, and managing programs and services for persons with chronic and severe mental illnesses and co-occurring substance use disorders. Mr. Wertheimer is a graduate of Haverford College, Yale University Divinity School and the University of Connecticut School of Social Work.

Marge Wherley has worked with housing and homeless services for over 30 years. One of her programs, the Family Homeless Prevention and Assistance Program, has helped 30,000 homeless children and parents to exit shelter.

Andrea White is the Chief Program Officer for CUCS's Housing Resource Center. She has worked in human services for over twenty years. Ms. White has designed and developed model programs for CUCS including a Transitional Living Community serving homeless, mentally ill women and the Times Square Hotel, a 652-unit supportive housing program serving low-income and formerly homeless people, many of whom have HIV/AIDS, mental illness, and/or chemical dependency. Ms. White has provided technical assistance for numerous groups throughout the US and has made presentations at national and international conferences. She has been awarded the American Psychiatric Association's Community Psychiatry Award for Outstanding Contribution to the Field of Community Health and Mental Health. Ms. White has also published on issues in housing homeless people and developing supportive services. Ms. White holds an MS in Social Work from Columbia University.



Matt White has been in the housing field for nearly 15 years, specializing in strategic planning and homeless system policy development, research and evaluation, and HMIS development. From 1998 through 2001, Mr. White served as the Associate Director of the Columbus, Ohio Community Shelter Board (CSB) and was primarily responsible for continuum of care planning, development, monitoring, and program evaluation. In 2002, he started an independent professional consulting practice, specializing in evaluation, facilitation, and planning in the homeless services sector. Mr. White joined the Abt team in 2005, adding to the firm's homeless and housing services sector practice. He has both a BA and MA from Columbia University in American Studies and a Masters degree in Urban Planning from the University of New Mexico.

Carol Wilkins, Director of Intergovernmental Policy, has more than 20 years of experience in public finance, human services, and policy work, including work with the California Legislature's Office of the Legislative Analyst, the State Assembly Ways and Means Committee, as Deputy Mayor of Finance in San Francisco, and as Finance Director for the San Francisco Housing Authority. She is the author of "Building a Model Managed Care System for Homeless Adults with Special Needs: The Health, Housing and Integrated Services Network" in *Current Issues in Public Health* and co-author of the chapter "Making Homeless Programs Accountable to Consumers, Funders and the Public", presented at the 1998 National Symposium on Homelessness Research and published by HUD and HHS.

Aisha Williams is a Center for Capacity Building Associate with the National Alliance to End Homelessness. She serves as resource for state and local governments, communities, and nonprofit programs wishing to implement the core strategies of their plans to prevent and end homelessness. Ms. Williams does this by providing technical assistance, training, strategy development and system analysis for clients. Prior to joining the Alliance in 2008, she served as a business and program development consultant with various corporate, government and nonprofit organizations. In her eight-plus years of experience, Ms. Williams provided services for dozens of organizations whose program development, management and evaluation needs mirrored those of the Alliance's clients. She has a Masters of Public Policy from Georgetown University and completed her undergraduate degree at Smith College.

Susan Williams currently serves as an Associate Director in the United States Department of Justice, Office on Violence Against Women (OVW). In this capacity, she supports the Director in managing division staff within the Rural Domestic Violence, Dating Violence, Sexual Assault, and Stalking Assistance Program Unit and the Transitional Housing Grants for Victims of Domestic Violence, Dating Violence, Stalking, or Sexual Assault Unit and provides leadership in the development and administration of Violence Against Women Act (VAWA) grant programs. Previously, Ms. Williams served as a grant program specialist within OVW managing a comprehensive portfolio of federal grants and technical assistance cooperative agreements designed to enhance the state, local, and tribal response to violence against women. She received her BA from Michigan State University and her Masters of Public Administration from the University of Pittsburgh.

Rick Wood is Director of Management Information Services and Evaluation at Rubicon Programs Inc., a San Francisco Bay Area agency whose mission is to create and deliver integrated solutions to profound social problems. Rubicon's purpose is to make a positive and lasting impact on people living in poverty and people living with disabilities, especially psychiatric disabilities. In 15 years at Rubicon, Mr. Wood helped develop and implement Rubicon's CICERO database application, which has been a pioneering system in social outcomes measurement. CICERO is a performance outcomes management system for the organization, supporting internal analysis, as well as the external reporting requirements of such disparate funding frameworks as McKinney-Vento Act/HMIS, Workforce Investment Act, MediCal (Medicaid) billing systems and demonstration projects.



Sara Zuiderveen is Assistant Commissioner for the Prevention Services division of the New York City Department of Homeless Services (DHS). She administers Homelessness Prevention contracts with social service vendors as well as prevention-related operations within DHS. Ms. Zuiderveen joined the agency in early 2004, assisting with the planning and implementation of the HomeBase homelessness prevention program, an innovative pilot program that was expanded city-wide in 2007. She has most recently been the Director of Program Analysis for Prevention Services, managing data collection, reporting, quality assurance, and ongoing program development. Before coming to DHS, Ms. Zuiderveen worked in the field of child abuse prevention as a program analyst for Healthy Families America, a national home visiting program based in Chicago. She holds a Masters degree in Public Policy from the University of Chicago.



WORKSHOP SPEAKER CONTACT INFORMATION

Tom Albanese, Associate
Abt Associates, Inc.
4429 Appian Way East, Apartment F
Gahanna, Ohio 43230
tom_albanese@abtassoc.com

Lynne Appel, Executive Director
So. California Alcohol & Drug Progs, Inc.
11500 Paramount Boulevard
Downey, CA 90241
lrappele@earthlink.net

Peggy Bailey, Program and Policy Analyst
National Alliance to End Homelessness
1518 K Street, NW, Suite 410
Washington, DC 20005
pbailey@naeh.org

Kerry William Bate, Director
Housing Authority of the County of Salt Lake
3595 South Main
South Salt Lake, UT 84115
kbate@hacsl.org

Samantha Batko, Capacity Building Associate
National Alliance to End Homelessness
1518 K Street, NW, Suite 410
Washington, DC 20005
sbatko@naeh.org

Elizabeth Benito, Project Director
Chicago Department of Family and Support Services
1615 W. Chicago
Chicago, IL 60622
elizabeth.benito@cityofchicago.org

Steve Berg, Vice President for Program and Policy
National Alliance to End Homelessness
1518 K Street, NW, Suite 410
Washington, DC 20005
sberg@naeh.org

Nancy Bernstine, Executive Director
National AIDS Housing Coalition
727 15th Street, NW Suite 210
Washington, DC 20005
nancy@nationalaidshousing.org

Tanya Broder, Attorney
National Immigration Law Center
405 14th Street, Suite 1400
Oakland, CA 94612
broder@nilc.org

Richard Brown, CEO
Monarch Housing Associates
29 Alden Street, Suite 1B
Cranford, NJ 07016
rbrown@monarchhousing.org

Stephanie Brown, Director, Housing and Homeless Services
MA Department of Transitional Assistance
600 Washington Street
Boston, MA 02111
stephanie.a.brown@state.ma.us

Jamey Burden, Assitant Director, Center for Capacity Building
National Alliance to End Homelessness
1518 K Street, NW, Suite 410
Washington, DC 20005
jburden@naeh.org

Martha Burt, Program Director
Urban Institute
2100 M Street, N.W.
Washington, DC 20037
mburt@urban.org

Phyllis Gilbert Chamberlain, Executive Director
Virginia Coalition to End Homelessness
POB 6613
Arlington, VA 22206
phyllis@vceh.org

Ji-Young Choi, FHPAP Manager
MN Housing Finance Agency
400 Sibley Street Suite 300
St. Paul, MN 55101
ji-young.choi@state.mn.us

Marilyn Cornell, Clinical Director
Veterans Village of San Diego
4141 Pacific Highway
San Diego, CA 92110
marilyn.cornell@vvsd.net

Mark Courtney, Executive Director
Partners for Our Children
4101 15th Avenue, NE
Seattle, WA 98105
markec@u.washington.edu

Dennis Culhane, Professor
University of Pennsylvania
3701 Locust Walk, University of Pennsylvania
Philadelphia, PA 19104
culhane@upenn.edu



Mary Cunningham, Senior Research Associate
The Urban Institute
2100 M Street
Washington, DC 20009
mcunningham@urban.org

Matthew Doherty, Director
Cororation for Supportive Housing
328 Maple Street, 4th floor
San Diego, CA 92103
matthew.doherty@csh.org

Gail Dorfman, County Commissioner
Hennepin County
300 S 6th Street, A-2400
Minneapolis, MN 55487
gail.dorfman@co.hennepin.mn.us

Liz Drapa, Associate Director
Corporation for Supportive Housing
205 W Randolph Street, 23rd floor
Chicago, IL 60606
liz.drapa@csh.org

Devra Edelman, Director of Programs
Hamilton Family Center
1631 Hayes Street
San Francisco, CA 94117
dedelman@hamiltonfamilycenter.org

Piper Ehlen, Staff Attorney
HomeBase
870 Market Street # 1228
San Francisco, CA 94102
piper@homebasecc.org

Phyllis Elkind, Coordinator
County of San Diego Health and Human Services Agency
3851 Rosecrans PO Box 85222
San Diego, CA 92186
phyllis.elkind@sdcounty.ca.gov

Danna Fischer, Legislative Director and Counsel
National Low Income Housing Coalition
727 15th Street
Washington, DC 20005
danna@nlihc.org

Maureen Friar
Consultant
119 Mill Creek Road #D-3-N
Ardmore, PA 19003
maureenfriar@yahoo.com

Samuel Girguis, Clinical Psychologist
Childrens Hospital Los Angeles
4650 Sunset Boulevard, MS #140
Los Angeles, CA 90027
sgirguis@chla.usc.edu

Richard Glickstein, Executive Director,
Homelessness Prevention
NYC Human Resources Administration
180 Water Street, Office 2117
New York City, New York 10038
glicksteinr@hra.nyc.gov

Brian Greenberg, Director
Shelter Network
1450 Chapin Avenue
Burlingame, CA 94010
bgreenberg@shelternetwork.org

Kathleen Guarino, Trauma Specialist
The National Center on Family Homelessness
181 Wells Avenue
Newton Centre, Massachusetts 02459
kathleen.guarino@familyhomelessness.org

Thomas Hameline, Senior Vice President
HELP USA
5 Hanover Square, 17th Floor
New York, NY 10004
thameline@helpusa.org

Damien Heath, Director, Center for Capacity Building
National Alliance to End Homelessness
1518 K Street, NW, Suite 410
Washington, DC 20005
dheath@naeh.org

Meghan Henry, Research Associate
National Alliance to End Homelessness
1518 K Street, NW, Suite 410
Washington, DC 20005
mhenry@naeh.org

Ranita Jain, Outcome Measurement Specialist
Building Changes
2014 E Madison, Suite 200
Seattle, WA 98122
Ranita.Jain@buildingchanges.org

Sarah Kahn, Director of Field Mobilization
National Alliance to End Homelessness
1518 K Street, NW, Suite 410
Washington, DC 20005
skahn@naeh.org



Katherine Kelly, Campaign Manager
Partnership for Strong Communities
227 Lawrence Street
Hartford, CT 06106
kate@ctpartnershiphousing.com

Chuck Kieffer, Executive Director
Washtenaw Housing Alliance
PO Box 7993
Ann Arbor, MI 48107
kiefferc@ewashtenaw.org

Tiffany Kingery
Multnomah County
421 SW Oak Street Suite 200
Portland, OR 97240
Tiffany.V.Kingery@co.multnomah.or.us

James Lepanto, Vice President
Mental Health Systems, Inc.
9465 Farnham Street
San Diego, CA 92123
jlepanto@mhsinc.org

Cecelia Levin, Domestic Violence Staff Attorney
National Law Center on Homelessness and Poverty
1411 K Street, NW, Suite 1400
Washington, DC 20005
clewin@nlchp.org

Sharan London, Executive Director
Montgomery County Coalition for the Homeless
600 B East Gude Drive
Rockville, MD 20850
Sharan@mcch.net

Eileen Lynch, Executive Director, Policy and Planning
NYC Department of Homeless Services
33 Beaver Street, 20th Floor
New York, NY 10004
elynych@dhs.nyc.gov

Sue Marshall, Executive Director
Community Partnership for the Prevention of Homelessness
801 Pennsylvania Avenue, SE #360
Washington, DC 20003
suemarshall@community-partnership.org

Sharon McDonald, Senior Policy Analyst
National Alliance to End Homelessness
1518 K Street, NW, Suite 410
Washington, DC 20005
smcdonald@naeh.org

Anna Melbin, Housing Specialist
National Network to End Domestic Violence
266 E Elm Street
Yarmouth, ME 04096
amelbin@nnev.org

Greg Morris, Program Manager
CATCH Program (City of Boise)
1276 River Street, Suite 201
Boise, ID 83702
gmmorris@cityofboise.org

Kay Moshier McDivitt, Community Homeless Advisor
for Lancaster County
United Way of Lancaster County
150 North Queen Street, Suite 602
Lancaster, PA 17603
kmcdivitt@co.lancaster.pa.us

Melissa Mowery, HomeBase Program Director
CAMBA, Inc.
1117 Eastern Parkway, 2nd Floor
Brooklyn, NY 11213
melissam@camba.org

Clare Nolan, Vice President
Harder+Company Community Research
299 Kansas Street
San Francisco, CA 94103
cnolan@harderco.com

Emily Nolan, Washington Families Fund Administrator
Building Changes
2014 E. Madison, Suite 200
Seattle, WA 98122
Emily.Nolan@buildingchanges.org

Laura Page, Early Interventionist
Antelope Valley Partners for Health
815 W. Lancaster Boulevard
Lancaster, CA 93534
lpage@avph.org

Jennifer Pasinosky, Program Manager
(Dependency Drug Court)
San Francisco Superior Court
400 McAllister Street, Room 205
San Francisco, CA 94102
jpasinosky@sftc.org

Tina Patterson, Executive Director
The Other Place
PO Box 1294
Dayton, Ohio 45401
tinap@theotherplace.org



Lloyd Pendleton, Director, Homeless Task Force
State of Utah
324 S State, Suite 500
SLC, Utah 84111
lpendleton@utah.gov

Mike Piepsny, Executive Director
Cleveland Tenants Organization
3631 Perkins Avenue, Suite 3A-4
Cleveland, Ohio 44114
mpiepsny@clevelandtenants.org

David Pollack, Fellow/Technical Director
ICF International
40 Wachusett Drive
Lexington, MA 02421
dpollack@icfi.com

LaKesha Pope, Youth Program and Policy Analyst
National Alliance to End Homelessness
1518 K Street, NW, Suite 410
Washington, DC 20005
lpope@naeh.org

Barbara Poppe, Executive Director
Community Shelter Board
111 Liberty Street, Suite 150
Columbus, OH 43215
bjpoppe@csb.org

Robert Pulster, Executive Director
Massachusetts ICHH
100 Cambridge Street, 4th floor
Boston, MA 02114
Robert.Pulster@state.ma.us

Sharon Rapport, Senior Program Manager, Policy & Planning
Corporation for Supportive Housing
800 S. Figueroa, Suite 790
Los Angeles, CA 90017
sharon.rapport@csh.org

Nan Roman, President
National Alliance to End Homelessness
1518 K Street, NW, Suite 410
Washington, DC 20005
nroman@naeh.org

Phyllis Ryan-Jackson, Executive Director
SafeHome Philadelphia
802 North Broad Street
Philadelphia, PA 19130
pryan@pceh.org

Jeff Schaffer, Southern California Director
Enterprise Community Partners
315 W. 9th Street, Suite 801
Los Angeles, CA 90015
jschaffer@enterprisecommunity.org

Ruth Schwartz, Executive Director
Shelter Partnership, Inc.
523 West Sixth Street, Suite 616
Los Angeles, CA 90014
rschwartz@shelterpartnership.org

John Selfridge, Director of Clinical Services
The Road Home
210 South Rio Grande Street
Salt Lake City, UT 84105
jsselfridge@theroadhome.org

Alice Shobe, Program Director
Building Changes
2014 E. Madison, Suite 200
Seattle, WA 98122
Alice.Shobe@buildingchanges.org

Steven Shum, Program Manager
Corporation for Supportive Housing
1330 Broadway, Suite 601
Oakland, CA 94612
steven.shum@csh.org

Erika Silver, Director of Programs
Human Solutions
12350 SE Powell Boulevard
Portland, OR 97236
esilver@humansolutions.org

Matthew Simmonds, President
Simtech Solutions Inc.
575 Washington Street, Suite 2C
Canton, MA 02021
Matt@simtechsolutions.com

Robert Snow, Senior Vice President
National Affordable Housing Trust
2335 N Bank Drive
Columbus, OH 43220
bsnow@naht.org

Brooke Spellman, Senior Associate
Abt Associates Inc.
4550 Montgomery Avenue, Suite 800N
Bethesda, MD 20814
brooke_spellman@abtassoc.com



Andrew Sperling, Director of Legislative Advocacy
National Alliance on Mental Illness
2107 Wilson Boulevard, #300
Arlington, VA 22201
andrew@nami.org

Ed Stellan, Director, Resource and Community
Development
Heartland Alliance
1207 W. Leland Avenue
Chicago, IL 60640
estellan@heartlandalliance.org

Beth Stokes, Executive Director
Hamilton Family Center
1631 Hayes Street
San Francisco, CA 95476
Bstokes@hamiltonfamilycenter.org

Elizabeth Stoltz, Program Director
Southern California Alcohol and Drug Programs, Inc. (SCADP)
11500 Paramount Avenue
Downey, CA 90241
liz.scadp@gmail.com

Norm Suchar, Senior Policy Analyst
National Alliance to End Homelessness
1518 K Street, NW, Suite 410
Washington, DC 20005
nsuchar@naeh.org

Tanya Tull, President/CEO
Beyond Shelter
1200 Wilshire Boulevard Suite 600
Los Angeles, California 90017
ttull@beyondshelter.org

Jamie Van Leeuwen, Project Manager
Denver's Road Home
1200 Federal Boulevard
Denver, CO 80204
jamie.vanleeuwen@denvergov.org

Suzanne Wagner, Director, CUCS Housing Resource Center
Center for Urban Community Services
198 East 121st Street, 6th Floor
NY, NY 10035
swagner@cucs.org

Nancy Wallis, Regional Director
Family Health Centers of San Diego
823 Gateway Center Way
San Diego, California 92102
nancyw@fhcsd.org

Carol Walter, Executive Director
CT Coalition to End Homelessness
77 Buckingham Street
Hartford, CT 0106
cwalter@cceh.org

Diana Waugh, Coordinator, In Our Own Voice,
Living With Mental Illness
NAMI San Diego
4480 30th Street
San Diego, CA 92116
dianawaugh@namisd.org

Laurel Weir, Policy Director
National Law Center on Homelessness & Poverty
1411 K Street, NW Suite 1400
Washington, DC 20005
lweir@nlchp.org

Joseph Weisbord, Director
Fannie Mae
780 Third Avenue, Suite 3802
New York, NY 10017
joseph_weisbord@fanniema.com

Deborah Werner, WCF Project Director
Advocates for Human Potential, Inc.
PO Box 267
Topanga, CA 90290
dwerner@ahpnet.com

David Wertheimer, Senior Program Officer
Bill & Melinda Gates Foundation
PO Box 23350
Seattle, WA 98102
david.wertheimer@gatesfoundation.org

Marge Wherley, Supervisor, Housing and
Homeless Initiatives
Hennepin County Human Services
A-1600 Government Center
300 South Sixth Street
Minneapolis, Minnesota 55487
marge.wherley@co.hennepin.mn.us

Andrea White, CPO
CUCS Housing Resource Center
198 E 121 Street
New York, NY 10035
andrea@w@fhcsd.org

Matt White, Associate
Abt Associates
4550 Montgomery Avenue
Bethesda, MD 20814
matt_white@abtassoc.com



Aisha Williams, Capacity Building Associate
National Alliance to End Homelessness
1518 K Street, NW, Suite 410
Washington, DC 20005
awilliams@naeh.org

Susan Williams, Associate Director
US Department of Justice/Office on Violence Against Women
800 K Street, Suite 920
Washington, DC 20530
susan.williams@usdoj.gov

Rick Wood, Director of MIS and Evaluation
Rubicon Programs Inc.
2500 Bissell Avenue
Richmond, CA 94804
rickw@rubiconprograms.org

Sara Zuiderveen, Assistant Commissioner,
Prevention Services
NYC Department of Homeless Services
33 Beaver Street, 20th Floor
New York, NY 10004
szuiderv@dhs.nyc.gov



National Alliance to
END HOMELESSNESS

ABOUT THE NATIONAL ALLIANCE TO END HOMELESSNESS

Our Work

The National Alliance to End Homelessness is a leading voice on the issue of homelessness. The Alliance analyzes policy and develops pragmatic, cost-effective policy solutions. We work collaboratively with the public, private, and nonprofit sectors to build state and local capacity, leading to stronger programs and policies that help communities achieve their goal of ending homelessness. We provide data and research to policymakers and elected officials in order to inform policy debates and educate the public and opinion leaders nationwide.

Alliance Staff

Nan Roman
President and CEO

Shalom Mulkey
Chief Operating Officer

Steve Berg
Vice President for Programs and Policy

Barbara Anzelmo
Director of Finance and Administration

Peggy Bailey
Program and Policy Analyst

Samantha Batko
Capacity Building Associate

Jamey Burden
Assistant Director, Center for Capacity Building

Damien Heath
Director, Center for Capacity Building

Meghan Henry
Research Associate

Richard Hooks Wayman
Senior Policy Analyst

Sarah Kahn
Director of Field Mobilization

D'Arcy Klinge
Meeting and Events Coordinator

Amanda Krusemark
Assistant to the President

Sharon McDonald
Senior Policy Analyst

LaKesha Pope
Youth Program and Policy Analyst

Elizabeth Roche
Director of Development

Elizabeth Santa-Donato
Office Coordinator

M William Sermons
Director, Homelessness Research Institute

Norm Suchar
Senior Policy Analyst

Aisha Williams
Capacity Building Associate

Lauren Wright
Media Associate



NATIONAL ALLIANCE TO END HOMELESSNESS BOARD OF DIRECTORS

Co-Chair

Susan G. Baker
Houston, TX
Co-Founder

Co-Chair

Mike Lowry
Renton, WA

Vice Chair

Gary M. Parsons
Sirius XM Radio, Inc.
Washington, DC

Secretary

Elizabeth Boyle
Chevy Chase, MD
Co-Founder

Treasurer

Robert D. Villency
Maurice Villency, Inc.
New York, NY

President

Nan P. Roman
Washington, DC

Board Members

Henry Cisneros
CityView
San Antonio, TX

Stephen Coyle
AFL-CIO Housing Investment Trust
Washington, DC

Kenneth M. Duberstein
The Duberstein Group
Washington, DC

G. Allan Kingston
Culver City, CA

John J. LaFalce
HoganWillig
Amherst, NY

Robert Levin
Fannie Mae
Washington, DC

D. William Moreau, Jr.
Barnes & Thornburg LLP
Washington, DC

Irene Mabry Moses
Faith Realty
Baltimore, MD

Barbara Poppe
Community Shelter Board
Columbus, OH

Michael R. Steed
Paladin Capital Group
Washington, DC

Robert D. Stillman
Chevy Chase, MD



CONFERENCE SCHOLARSHIP PROGRAM

The National Alliance to End Homelessness has established a Scholarship Program to assist homeless and formerly homeless people, as well as individuals who work with organizations that cannot afford to cover the full cost of participating in the conference and/or travel and hotel costs for the conference.

Criteria for scholarship awards are based on financial need, geographic distribution, targeted population(s) served, and the leadership skills the applicant will be able to bring back to his/her community. The number of scholarships available depends upon the total conference funding. We would like to thank the following Scholarship Fund contributors:

SCHOLARSHIP FUND CONTRIBUTORS

Horne Family Foundation

Mercy Housing

Center for Urban Community Services

Local Initiatives Support Corporation

Regional Taskforce on the Homeless San Diego



SAVE THE DATE!

The National Alliance to End Homelessness'

National Conference on Ending

Homelessness will be held July 29-31, 2009

at the Renaissance Washington, DC Hotel

in Washington, DC. Visit the Alliance

website frequently for conference updates at

www.endhomelessness.org.



NOTES



MARINA TOWER: FIRST FLOOR

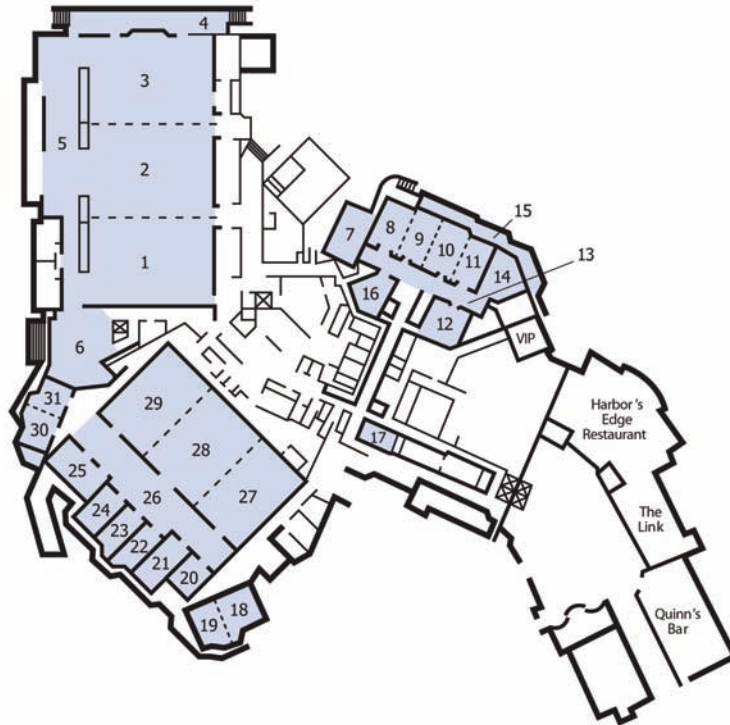

Key

- | | |
|---|--|
| Room 1: Grande Ballroom A | Room 17: Maritime Boardroom |
| Room 2: Grande Ballroom B | Room 18: Seabreeze Room 1 |
| Room 3: Grande Ballroom C | Room 19: Seabreeze Room 2 |
| Room 4: Grande Ballroom Terrace | Room 20: Marina Room 1 |
| Room 5: Grande Ballroom Foyer | Room 21: Marina Room 2 |
| Room 6: Bayview Foyer | Room 22: Marina Room 3 |
| Room 7: Executive Conference Room 1 | Room 23: Marina Room 4 |
| Room 8: Executive Conference Room 2A | Room 24: Marina Room 5 |
| Room 9: Executive Conference Room 2B | Room 25: Marina Room 6 |
| Room 10: Executive Conference Room 3A | Room 26: Harbor Island Foyer |
| Room 11: Executive Conference Room 3B | Room 27: Harbor Island Ballroom 1 |
| Room 12: Executive Conference Room 4 | Room 28: Harbor Island Ballroom 2 |
| Room 13: Executive Center Foyer | Room 29: Harbor Island Ballroom 3 |
| Room 14: Executive Center Foyer Buffet | Room 30: Spinnaker Room 1 |
| Room 15: Executive Center Terrace | Room 31: Spinnaker Room 2 |
| Room 16: Executive Boardroom | |



National Alliance to
END HOMELESSNESS

1518 K STREET, NW, SUITE 410

WASHINGTON, DC 20005

TEL 202-638-1526

FAX 202-638-4664

www.endhomelessness.org